

# 10" - 12" - 14" 10-12LM & E14 lines

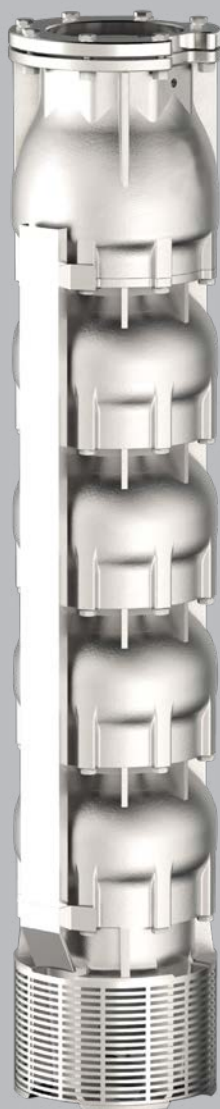

## CARATTERISTICHE COSTRUTTIVE / CONSTRUCTION FEATURES CARACTERÍSTICAS CONSTRUCTIVAS / CARACTÉRISTIQUES D'EXÉCUTION

Corpo d'Aspirazione e di Mandata Suction and delivery outlet Caja de Aspiracion y de Impulsión Cage d'aspiration et de refoulement	<b>AISI 304 (LMS) AISI 316 (LMX - EX) Duplex (LMD - ED) Cast iron (E)</b>
Corpo Valvola Valve body Valvula Plat	<b>AISI 304 (LMS) AISI 316 (LMX - EX) Duplex (LMD - ED) Cast iron (E)</b>
Giranti e diffusori Impellers and diffusers Rodetes y difusores Turbines et diffuseurs	<b>AISI 304 (LMS) AISI 316 (LMX - EX) Duplex (LMD - ED) Cast iron (E)</b>
Bronzina superiore Upper bushings Cojinete superior Coussinet de bague supérieur	<b>NBR</b>
Albero corpo pompa Shaft pump side Eje cuerpo bomba Arbre pompe	<b>AISI 304 (LMS) AISI 316 (LMX) Duplex (LMD) AISI 431 (E - EX - ED)</b>
Quantità di sabbia nell'acqua Quantity of sand in the water Cantidad de arena en el agua Quantité de sable dans l'eau	<b>max 100 gr/m<sup>3</sup></b>

## MOTORE / MOTOR / MOTOR / MOTEUR

Asincrono 2 poli Asynchronous 2 pole Asincrono 2 polos Asinchrone 2 pôles	riavvolgibile in bagno d'acqua rewindable water cooled bobinabile en baño de agua enroulable en bain d'eau
Classe di isolamento Insulation class Clase de aislamiento Classe d'isolation	<b>Y (max 30 °C) - PPC winding type F (max 50 °C) - PE2+PA or LPE winding type</b>
Grado di protezione Protection degree Grado de protección protection	<b>IP68</b>
Temperatura del liquido Liquid temperature Temperatura del líquido Température du liquide	<b>max 30 °C (max 50 °C on request)</b>
Massima profondità d'immersione Maximum immersion depth Sumergencia máxima Profondité maximum d'immersion	<b>350 m</b>

Pompe sommerse centrifughe multistadio per pozzi da 10", 12" e 14". Valvola di ritegno incorporata nella bocca di mandata. Flangia di accoppiamento al motore secondo la normativa NEMA. Applicazioni civili e agricole sono tra le più comuni.

Submersible multistage centrifugal pumps for 10", 12" and 14" wells. Check valve built into the delivery outlet. Pump flange for coupling with motors are made according to NEMA standards. Most common applications are civil and agricultural.

Bombas sumergibles para pozos de 10", 12" y 14". Válvula de retención incorporada en la boca de impulsión. Brida de conexión al motor según norma NEMA. Utilizadas en particular para aplicaciones civiles y agrícolas.

Pompes immergées centrifuges multietagées pour puits de 10", 12" et 14". Clapet de retenue incorporé dans l'orifice de refoulement. Bride d'accouplement au moteur est exécutée selon normes NEMA. Les applications civiles et agricoles sont parmi les plus communes.

# 10" 10LM 190

AISI 304 (LMS), AISI 316 (LMX), Duplex (LMD)

Motor 50 Hz - 2900 rpm				Q									
TYPE	Power		400 V A	l/min l/sec m³/h	0	700	1800	2200	2600	3000	3400	3800	4000
	kW	HP			0	11,7	30,0	36,7	43,3	50,0	56,7	63,3	66,7
10LM 190/01 DR20	18,5	25	38,3	H[m]	35	34	32	30	27	24	21	16	14
10LM 190/01	22	30	45,1		42	41	38	36	34	31	28	23	21
10LM 190/02 DR10	37	50	75,8		76	75	70	66	61	55	48	40	35
10LM 190/02	45	60	86,3		83	82	77	73	68	62	55	47	41
10LM 190/03 DR20	55	75	106,2		104	102	95	89	82	73	62	49	42
10LM 190/03	66	90	126,0		125	124	115	109	102	93	83	70	62
10LM 190/04 DR10	75	100	143,2		152	150	140	132	122	110	96	79	70
10LM 190/04	92	125	175,1		166	165	154	146	136	124	110	94	82
10LM 190/05 DR10	110	150	211,0		190	188	175	165	153	138	120	99	87
10LM 190/05 D	110	150	211,0		208	206	192	182	170	155	138	117	103
10LM 190/06 DR10 D	130	175	245,3		228	225	210	198	184	166	144	119	104
10LM 190/06 D	130	175	245,3		250	247	230	218	204	186	166	140	124

Motor 50 Hz 2900 rpm	Dimensions (mm)			Weight (kg)	
TYPE	A	B	C	M	P
10LM 190/01 DR20	1616	625	991	83	41
10LM 190/01	1696	625	1071	92	41
10LM 190/02 DR10	2146	805	1341	118	56
10LM 190/02	1928	805	1123	178	56
10LM 190/03 DR20	2218	985	1233	200	72
10LM 190/03	2287	985	1302	214	72
10LM 190/04 DR10	2548	1165	1383	230	87
10LM 190/04	2748	1165	1583	270	87
10LM 190/05 DR10	2898	1165	1733	300	87
10LM 190/05 D	2898	1165	1733	300	87
10LM 190/06 DR10 D	2799	1165	1634	385	87
10LM 190/06 D	2799	1165	1634	385	87

Max Eff. % DR20 =	76,5
Max Eff. % DR10 =	77,5
Max Eff. % =	77
Max kW / St. DR20 =	16
Max kW / St. DR10 =	18,5
Max kW / St. =	20,8

Q (flow)	25%	50%	75%	100%
NPSH (m)	3,4	5	7,8	11,8

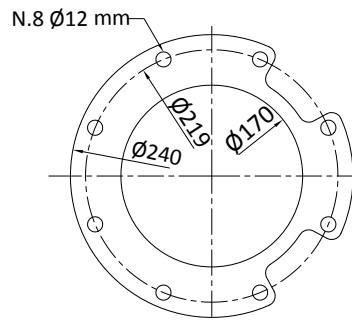
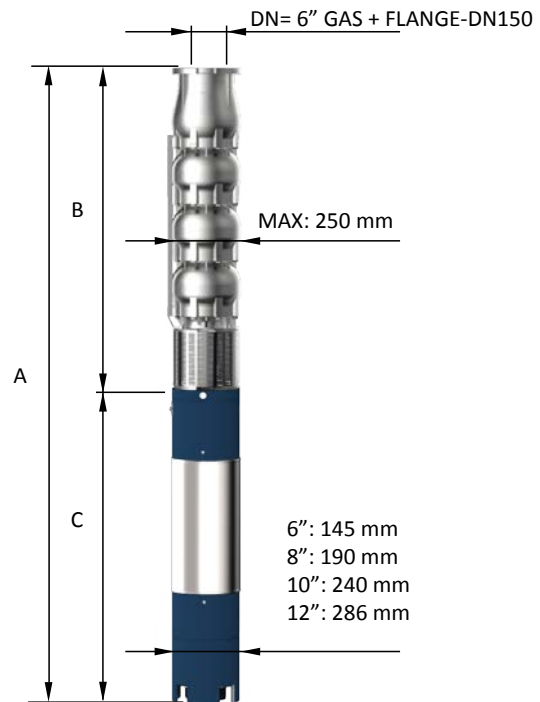

FOR COMMERCIAL TUBE  
EXTERNAL DIAMETER: 168,3 mm

# 10" 10LM 190

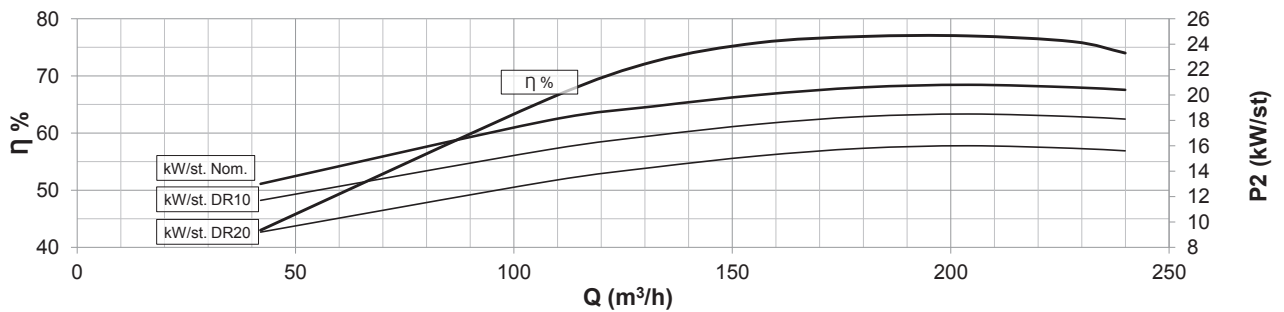
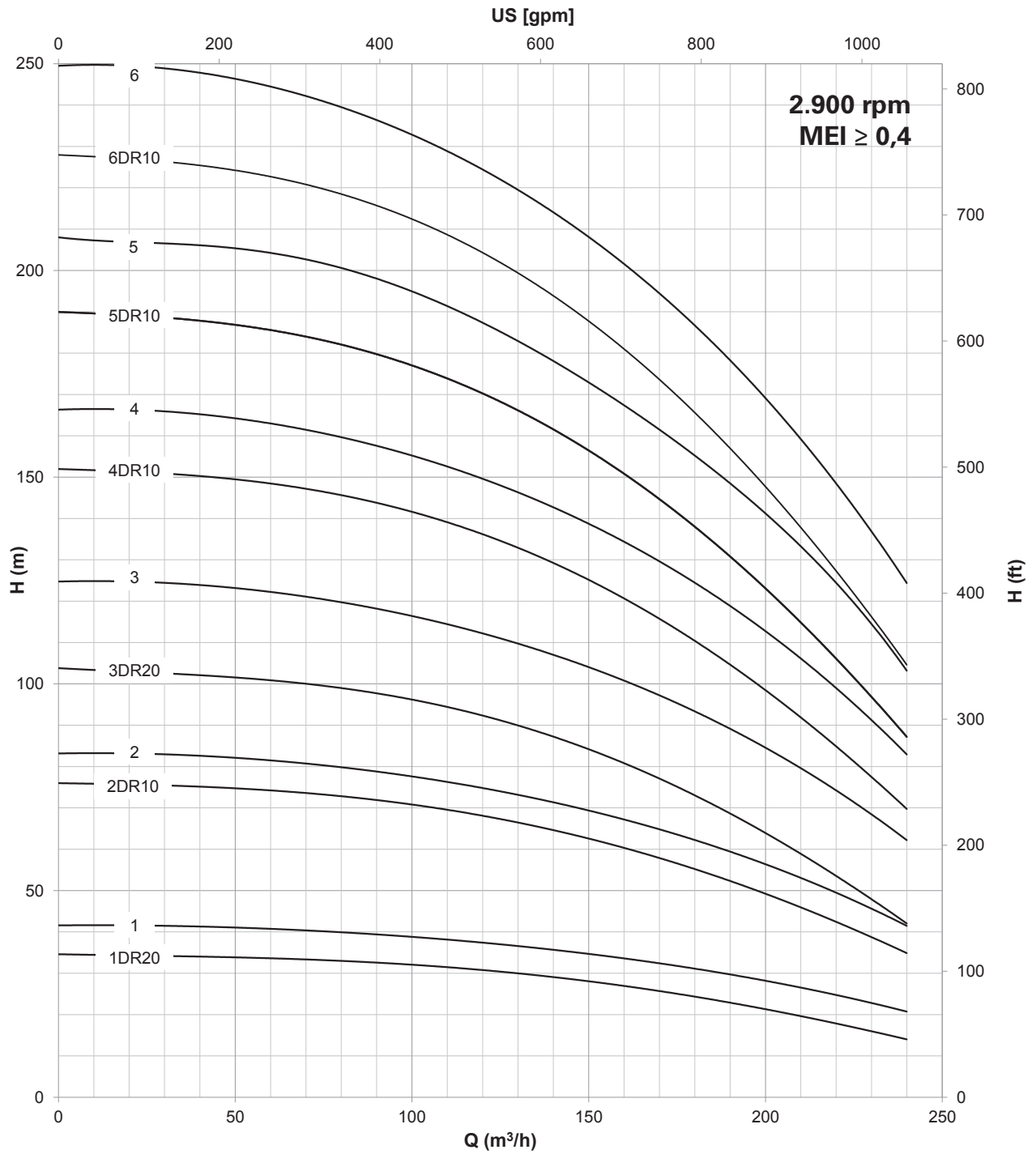

Compatibilità con acqua potabile DM 174 - Drinking water compatibility according DM 174  
 MEI ≥ 0,4 (direttiva EU No. 547/2012 - regulation EU N. 547/2012)  
 Per modelli con meno di 3 stadi ridurre l'eff. % del -5% / Models with less than 3 stages reduce the % eff. of 5%



# 10" 10LM 190

AISI 304 (LMS), AISI 316 (LMX), Duplex (LMD)

Motor 50 Hz - 2900 rpm				Q									
TYPE	Power		400 V A	l/min l/sec m <sup>3</sup> /h	0	700	1800	2200	2600	3000	3400	3800	4000
	kW	HP			0	11,7	30,0	36,7	43,3	50,0	56,7	63,3	66,7
10LM 190/07 DR10 D	130	175	245,3	H[m]	266	263	245	231	214	193	168	139	122
10LM 190/07 D	150	200	277,2		291	288	269	255	238	217	193	164	144
10LM 190/08 DR10 D	150	200	277,2		304	300	280	264	245	221	192	158	139
10LM 190/08 D	185	250	342,2		333	330	307	291	272	248	221	187	165
10LM 190/09 D	220	300	430,0		374	371	346	328	306	279	248	211	185
10LM 190/010 D	220	300	430,0		416	412	384	364	340	310	276	234	206
10LM 190/011 D	250	340	481,0		458	453	422	400	374	341	304	257	227

Motor 50 Hz 2900 rpm	Dimensions (mm)			Weight (kg)	
TYPE	A	B	C	M	P
10LM 190/07 DR10 D	3339	1705	1634	385	134
10LM 190/07 D	3439	1705	1734	415	134
10LM 190/08 DR10 D	3619	1885	1734	415	149
10LM 190/08 D	3869	1885	1984	480	149
10LM 190/09 D	4175	2065	2110	700	165
10LM 190/010 D	4355	2245	2110	700	180
10LM 190/011 D	4705	2425	2280	775	196

Max Eff. % DR20 =	76,5
Max Eff. % DR10 =	77,5
Max Eff. % =	77
Max kW / St. DR20 =	16
Max kW / St. DR10 =	18,5
Max kW / St. =	20,8

Q (flow)	25%	50%	75%	100%
NPSH (m)	3,4	5	7,8	11,8

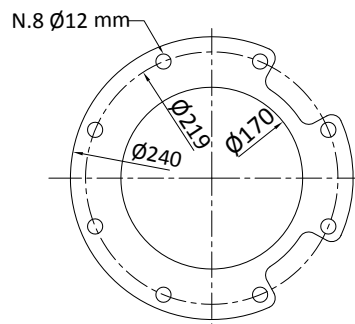
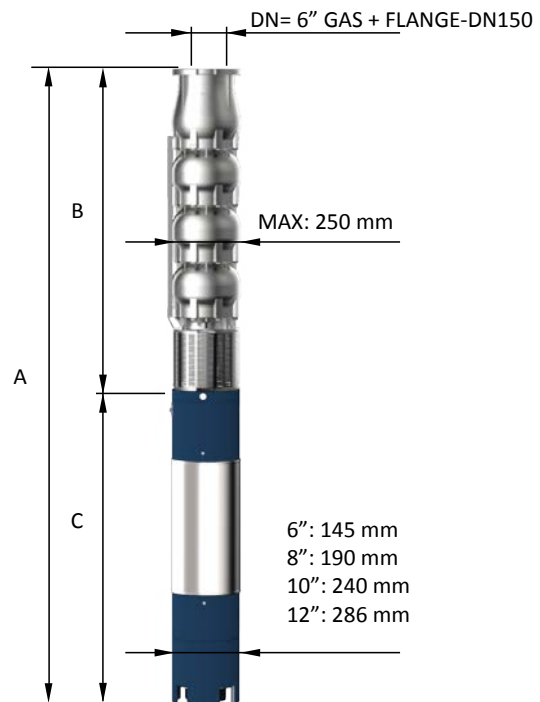

FOR COMMERCIAL TUBE  
EXTERNAL DIAMETER: 168,3 mm

# 10" 10LM 190

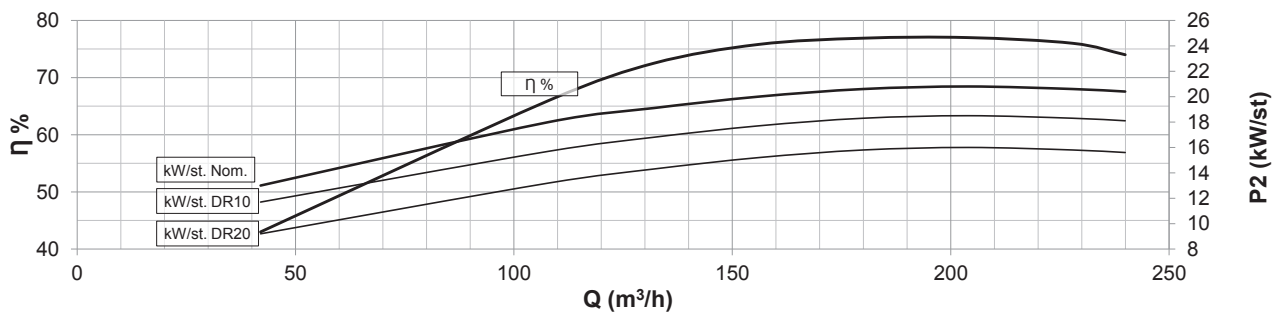
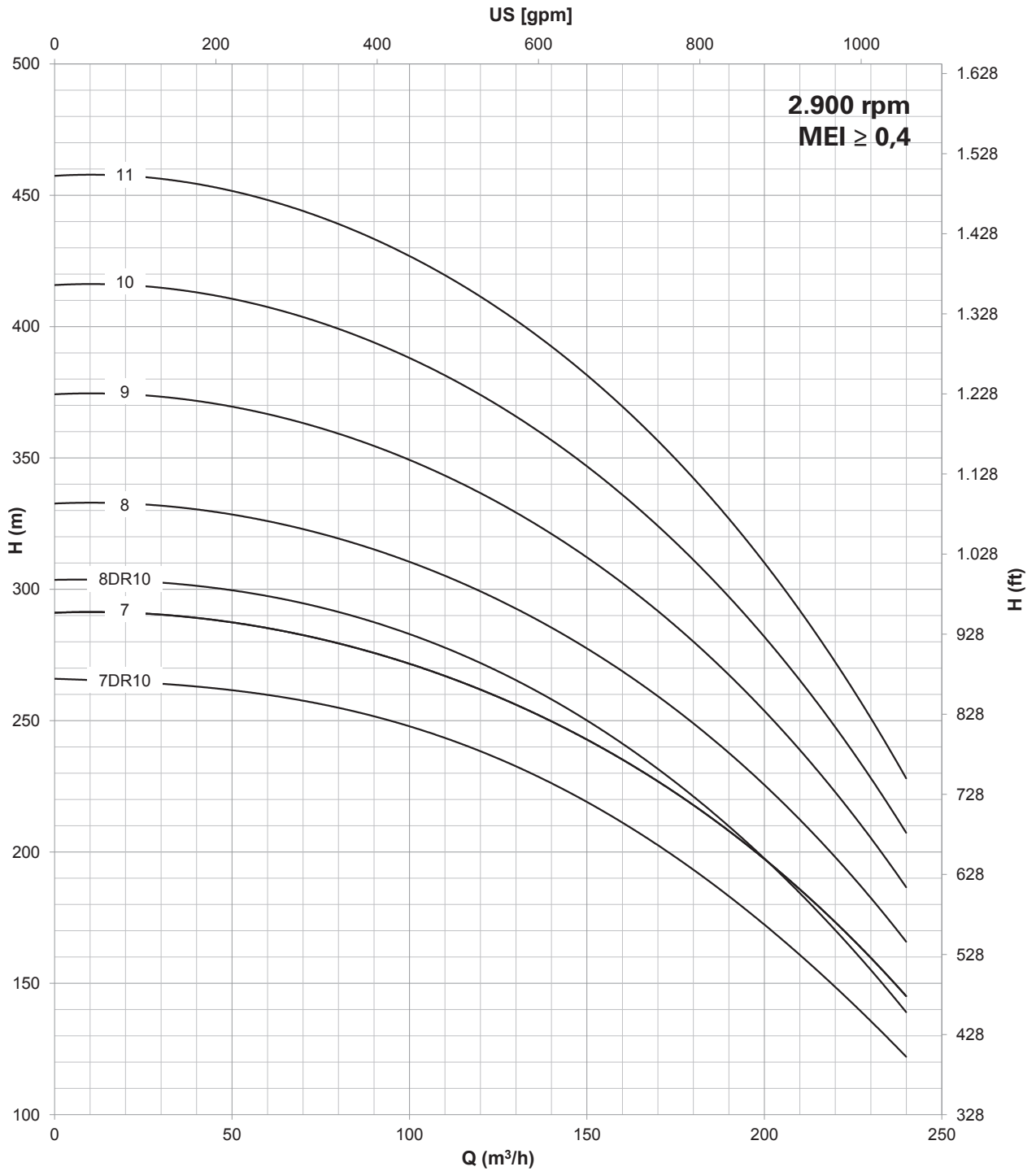

Compatibilità con acqua potabile DM 174 - Drinking water compatibility according DM 174  
 MEI ≥ 0,4 (direttiva EU No. 547/2012 - regulation EU N. 547/2012)  
 Per modelli con meno di 3 stadi ridurre l'eff. % del -5% / Models with less than 3 stages reduce the % eff. of 5%



# 10" 10LM 230

AISI 304 (LMS), AISI 316 (LMX), Duplex (LMD)

Motor 50 Hz - 2900 rpm				Q									
TYPE	Power		400 V A	l/min l/sec m <sup>3</sup> /h	0	800	2200	2600	3000	3400	3800	4200	4600
	kW	HP			0	13,3	36,7	43,3	50,0	56,7	63,3	70,0	76,7
10LM 230/01 DR20	18,5	25	38,3	H[m]	37	36	31	29	27	25	23	19	16
10LM 230/01	26	35	52,9		44	43	38	36	34	32	30	26	23
10LM 230/02 DR20	37	50	75,8		74	71	62	58	54	50	45	38	32
10LM 230/02	55	75	106,2		88	85	75	72	68	64	59	53	46
10LM 230/03 DR20	55	75	106,2		110	107	93	87	81	75	68	57	48
10LM 230/03 DR10	66	90	126,0		121	116	102	98	92	86	78	68	59
10LM 230/03	75	100	143,2		131	128	113	108	102	96	89	79	69
10LM 230/04 DR10	92	125	175,1		162	154	136	130	122	114	104	91	78
10LM 230/04	92	125	175,1		175	170	150	144	136	128	118	106	92
10LM 230/05 DR10 D	110	150	211,0		202	193	170	163	153	143	130	114	98
10LM 230/05 D	130	175	245,3		219	213	188	180	170	160	148	132	115
10LM 230/06 DR10 D	130	175	245,3		242	231	204	195	183	171	156	137	117
10LM 230/06 D	150	200	277,2		263	255	225	216	204	192	178	159	138

Motor 50 Hz 2900 rpm	Dimensions (mm)			Weight (kg)	
TYPE	A	B	C	M	P
10LM 230/01 DR20	1616	625	991	83	41
10LM 230/01	1806	625	1181	100	41
10LM 230/02 DR20	2146	805	1341	118	56
10LM 230/02	2038	805	1233	200	56
10LM 230/03 DR20	2218	985	1233	200	72
10LM 230/03 DR10	2287	985	1302	214	72
10LM 230/03	2368	985	1383	230	72
10LM 230/04 DR10	2748	1165	1583	270	87
10LM 230/04	2748	1165	1583	270	87
10LM 230/05 DR10 D	3078	1345	1733	300	103
10LM 230/05 D	3078	1345	1733	300	103
10LM 230/06 DR10 D	3159	1525	1634	385	118
10LM 230/06 D	3159	1525	1634	385	118

Max Eff. % DR20 =	78,4
Max Eff. % DR10 =	79,5
Max Eff. % =	79,2
Max kW / St. DR20 =	17,5
Max kW / St. DR10 =	19,5
Max kW / St. =	22,8

Q (flow)	25%	50%	75%	100%
NPSH (m)	3,4	5	7,8	11,8

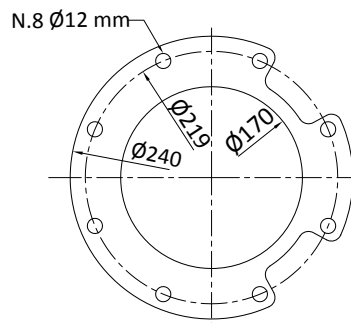
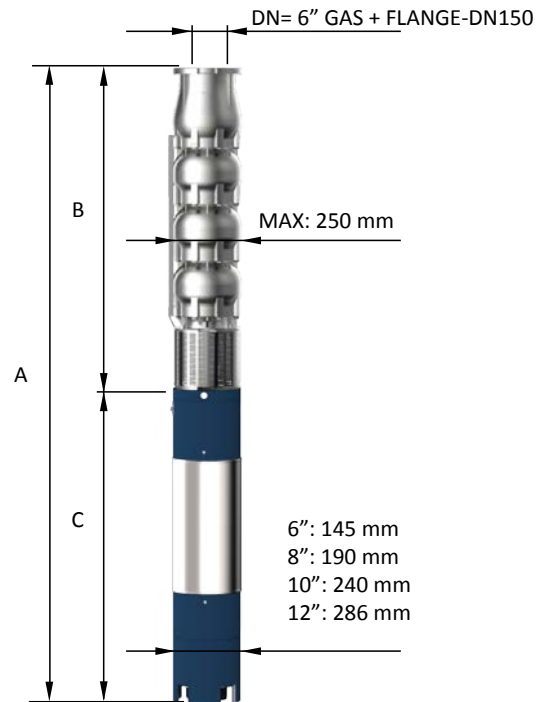

FOR COMMERCIAL TUBE  
EXTERNAL DIAMETER: 168,3 mm

# 10" 10LM 230

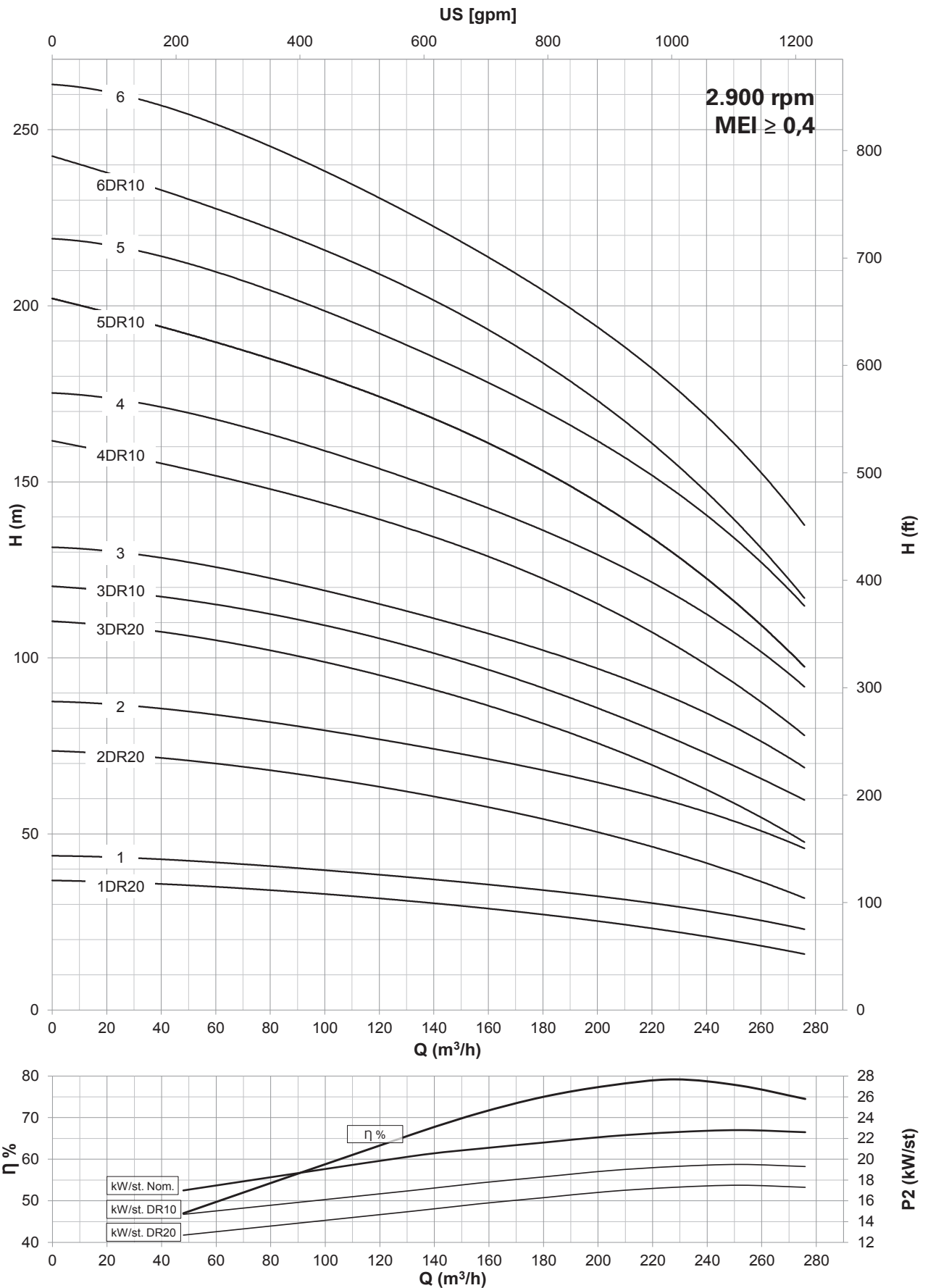

Compatibilità con acqua potabile DM 174 - Drinking water compatibility according DM 174  
 MEI ≥ 0,4 (direttiva EU No. 547/2012 - regulation EU N. 547/2012)  
 Per modelli con meno di 3 stadi ridurre l'eff. % del -5% / Models with less than 3 stages reduce the % eff. of 5%



# 10" 10LM 230

AISI 304 (LMS), AISI 316 (LMX), Duplex (LMD)

Motor 50 Hz - 2900 rpm				Q									
TYPE	Power		400 V A	l/min l/sec m <sup>3</sup> /h	0	800	2200	2600	3000	3400	3800	4200	4600
	kW	HP			0	13,3	36,7	43,3	50,0	56,7	63,3	70,0	76,7
10LM 230/07 DR10 D	150	200	277,2	H[m]	283	270	238	228	214	200	182	160	137
10LM 230/07 D	165	225	313,3		307	298	263	252	238	224	207	185	161
10LM 230/08 DR10 D	165	225	313,3		323	308	272	261	245	229	208	182	157
10LM 230/08 D	185	250	342,2		350	340	301	288	272	256	237	211	184
10LM 230/09 D	220	300	430,0		394	383	338	324	306	288	266	238	207
10LM 230/10 D	250	340	481,0		438	425	376	360	340	320	296	264	230
10LM 230/11 D	250	340	481,0		482	468	413	396	374	352	326	291	253

Motor 50 Hz 2900 rpm	Dimensions (mm)			Weight (kg)	
TYPE	A	B	C	M	P
10LM 230/07 DR10 D	3439	1705	1734	415	134
10LM 230/07 D	3559	1705	1854	444	134
10LM 230/08 DR10 D	3739	1885	1854	444	149
10LM 230/08 D	3869	1885	1984	480	149
10LM 230/09 D	4175	2065	2110	700	165
10LM 230/10 D	4355	2245	2110	700	180
10LM 230/11 D	4705	2425	2280	775	196

Max Eff. % DR20 =	78,4
Max Eff. % DR10 =	79,5
Max Eff. % =	79,2
Max kW / St. DR20 =	17,5
Max kW / St. DR10 =	19,5
Max kW / St. =	22,8

Q (flow)	25%	50%	75%	100%
NPSH (m)	3,4	5	7,8	11,8

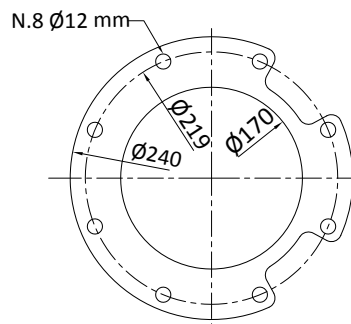
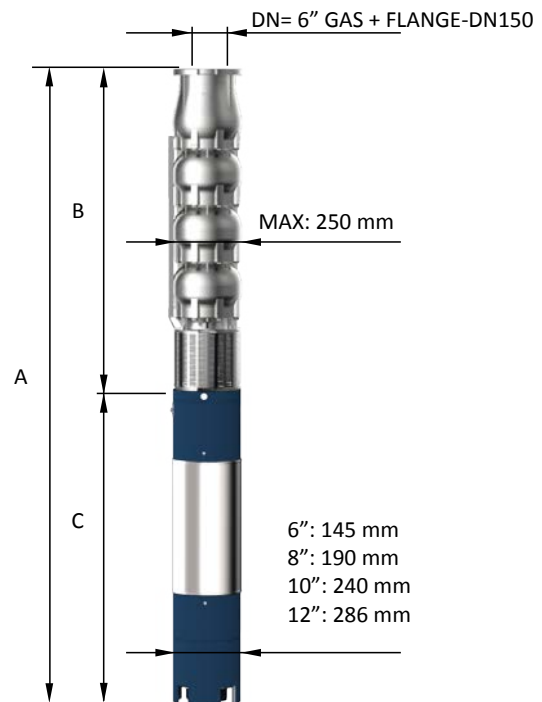

FOR COMMERCIAL TUBE  
EXTERNAL DIAMETER: 168,3 mm



# 10" 10LM 230

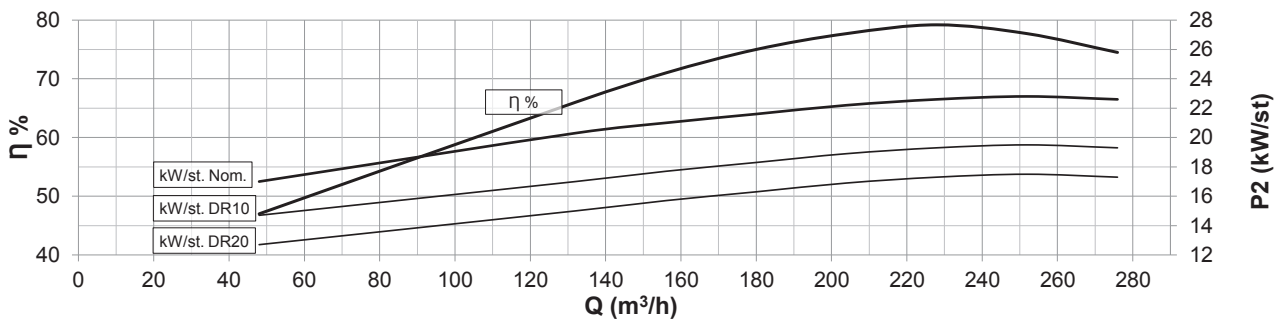
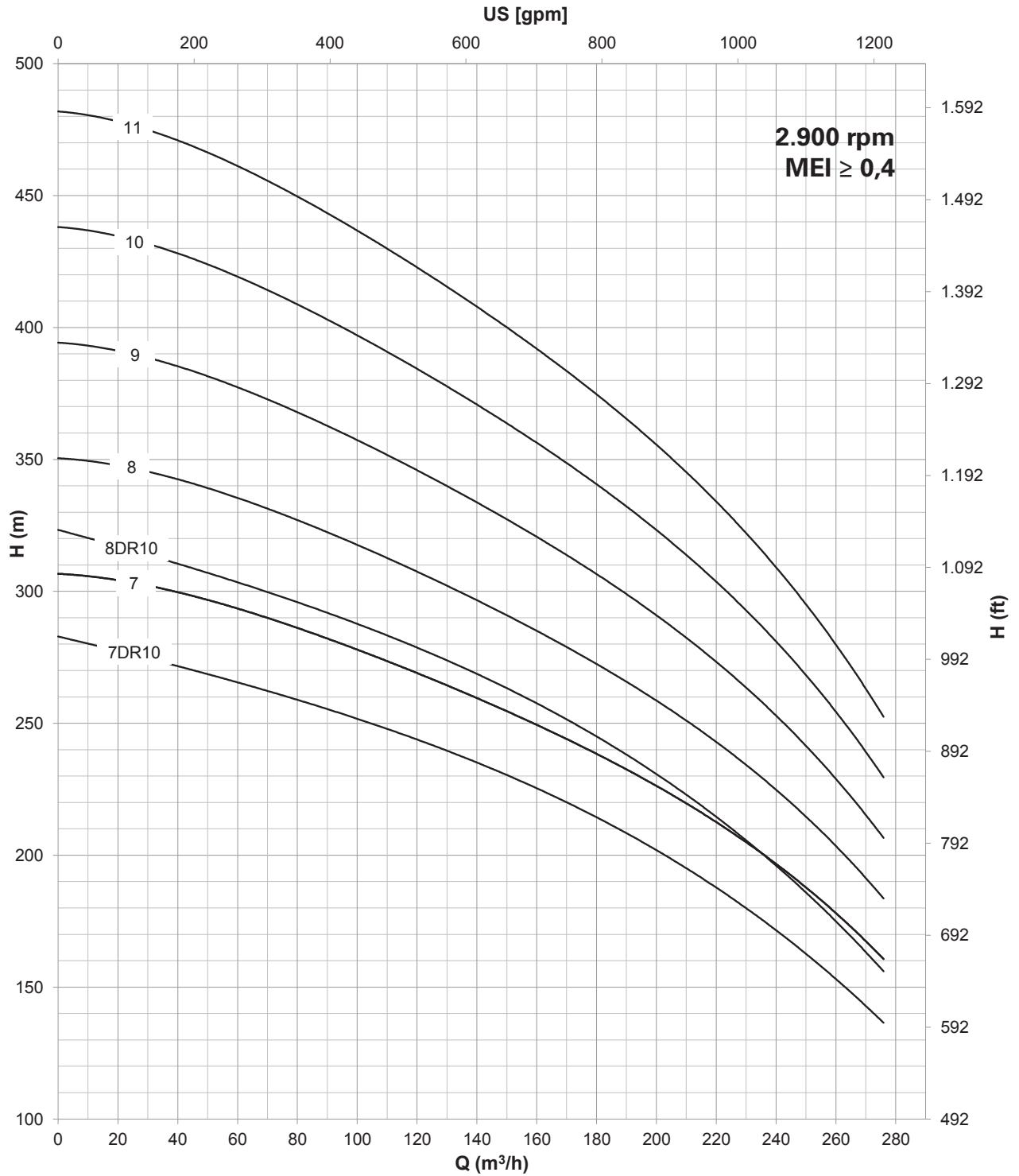

Compatibilità con acqua potabile DM 174 - Drinking water compatibility according DM 174  
 MEI ≥ 0,4 (direttiva EU No. 547/2012 - regulation EU N. 547/2012)  
 Per modelli con meno di 3 stadi ridurre l'eff. % del -5% / Models with less than 3 stages reduce the % eff. of 5%



# 10" 10LM 250

AISI 304 (LMS), AISI 316 (LMX), Duplex (LMD)

Motor 50 Hz - 2900 rpm				Q									
TYPE	Power		400 V A	l/min l/sec m <sup>3</sup> /h	0	1000	3200	3600	4000	4400	4800	5000	5200
	kW	HP			0	16,7	53,3	60,0	66,7	73,3	80,0	83,3	86,7
10LM 250/01 DR20	18,5	25	38,3	H[m]	31	31	27	25	23	21	18	17	14
10LM 250/01	30	40	61,1		44	42	34	32	30	28	26	25	24
10LM 250/02 DR20	37	50	75,8		63	62	54	50	46	42	36	33	27
10LM 250/02	55	75	106,2		88	84	67	64	59	56	52	50	48
10LM 250/03 DR10	75	100	143,2		107	107	93	86	80	73	65	59	53
10LM 250/03	92	125	175,1		132	126	101	96	89	83	78	75	72
10LM 250/04 DR10	92	125	175,1		143	142	124	115	107	97	87	79	70
10LM 250/04 D	110	150	211,0		176	168	134	128	118	111	104	100	96
10LM 250/05 DR10 D	130	175	245,3		179	178	155	144	134	121	109	99	88
10LM 250/05 D	150	200	277,2		220	210	168	160	148	139	130	125	120
10LM 250/06 D	165	225	313,3	264	252	202	192	178	167	156	150	144	

Motor 50 Hz 2900 rpm	Dimensions (mm)			Weight (kg)	
TYPE	A	B	C	M	P
10LM 250/01 DR20	1616	625	991	83	41
10LM 250/01	1876	625	1251	108	41
10LM 250/02 DR20	2146	805	1341	118	57
10LM 250/02	2038	805	1233	200	57
10LM 250/03 DR10	2368	985	1383	230	72
10LM 250/03	2568	985	1583	270	72
10LM 250/04 DR10	2748	1165	1583	270	88
10LM 250/04 D	2898	1165	1733	300	88
10LM 250/05 DR10 D	2979	1345	1634	385	103
10LM 250/05 D	2979	1345	1634	385	103
10LM 250/06 D	3379	1525	1854	444	119

Max Eff. % DR20 =	79
Max Eff. % DR10 =	79,5
Max Eff. % =	79,3
Max kW / St. DR20 =	18
Max kW / St. DR10 =	22,5
Max kW / St. =	27,5

Q (flow)	25%	50%	75%	100%
NPSH (m)	3,4	5	7,8	11,8

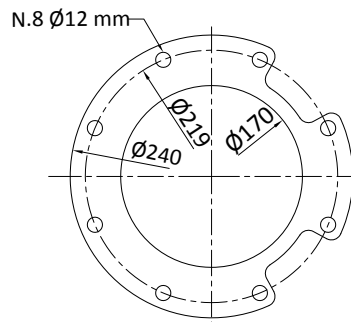
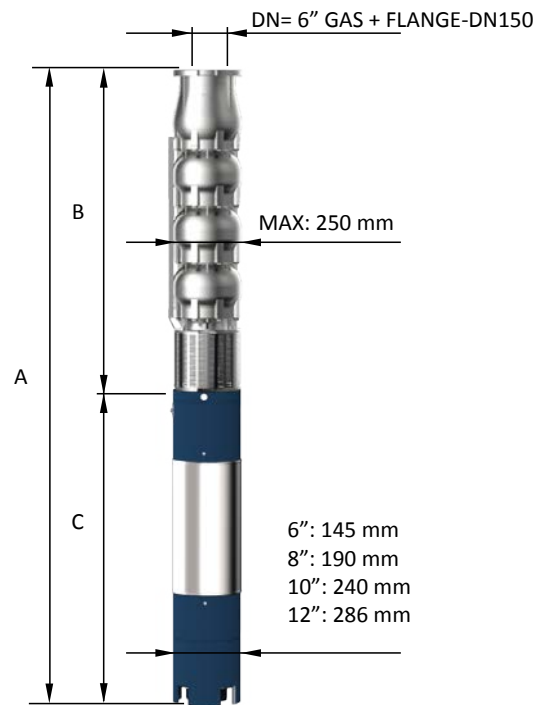

FOR COMMERCIAL TUBE  
EXTERNAL DIAMETER: 168,3 mm

# 10" 10LM 250

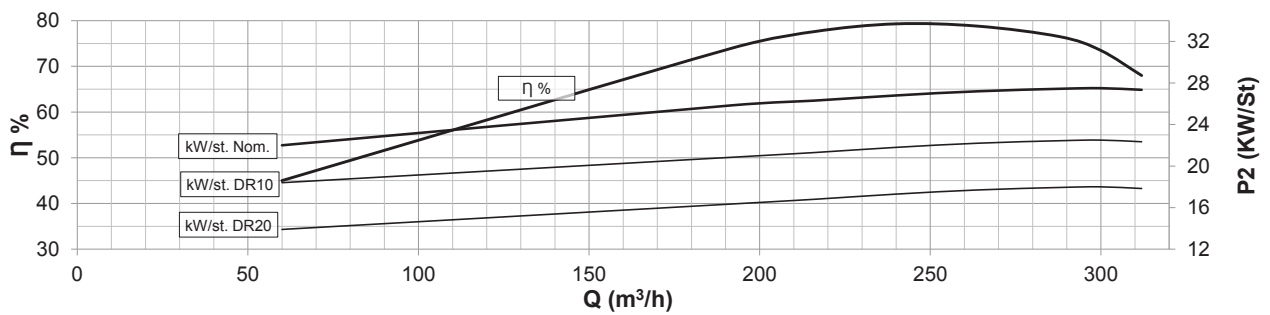
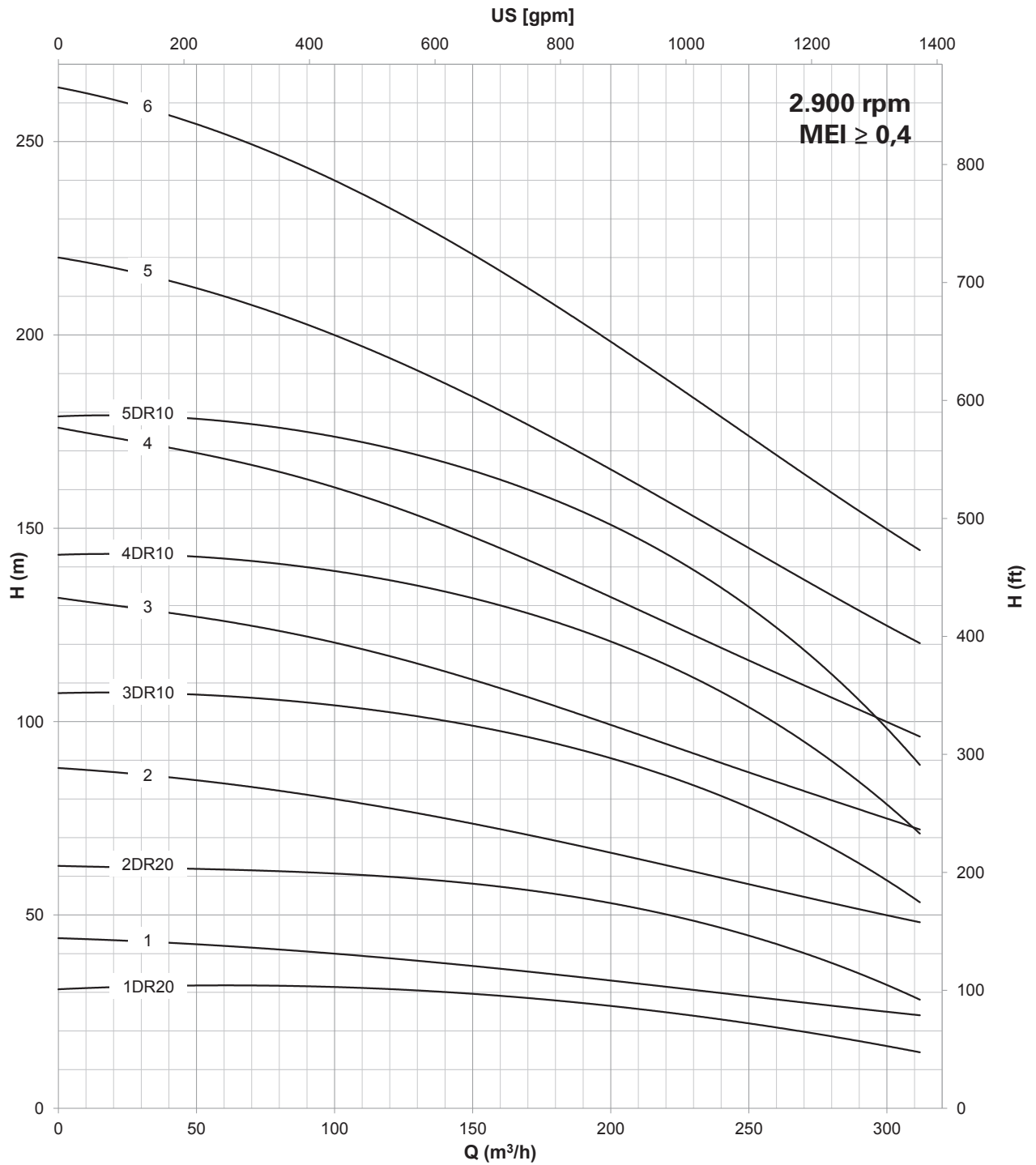

Compatibilità con acqua potabile DM 174 - Drinking water compatibility according DM 174  
 MEI ≥ 0,4 (direttiva EU No. 547/2012 - regulation EU N. 547/2012)  
 Per modelli con meno di 3 stadi ridurre l'eff. % del -5% / Models with less than 3 stages reduce the % eff. of 5%

# 10" 10LM 250

AISI 304 (LMS), AISI 316 (LMX), Duplex (LMD)

Motor 50 Hz - 2900 rpm				Q									
TYPE	Power		400 V	l/min l/sec m <sup>3</sup> /h	0	1000	3200	3600	4000	4400	4800	5000	5200
	kW	HP			A	0	16,7	53,3	60,0	66,7	73,3	80,0	83,3
10LM 250/07 DR10 D	165	225	313,3	H[m]	251	249	217	202	188	169	153	139	123
10LM 250/07 D	220	300	430,0		308	294	235	224	207	195	182	175	168
10LM 250/08 D	220	300	430,0		352	336	269	256	237	222	208	200	192
10LM 250/09 D	250	340	481,0		396	378	302	288	266	250	234	225	216
10LM 250/10 D	300	400	551,0		440	420	336	320	296	278	260	250	240
10LM 250/11 D	330	450	620,0		484	462	370	352	326	306	286	275	264
10LM 250/12 D	330	450	620,0		528	504	403	384	355	334	312	300	288

Motor 50 Hz 2900 rpm	Dimensions (mm)			Weight (kg)	
TYPE	A	B	C	M	P
10LM 250/07 DR10 D	3559	1705	1854	444	134
10LM 250/07 D	3815	1705	2110	700	134
10LM 250/08 D	3995	1885	2110	700	150
10LM 250/09 D	4345	2065	2280	775	165
10LM 250/10 D	4525	2245	2280	775	181
10LM 250/11 D	4705	2425	2280	775	196
10LM 250/12 D	4765	2605	2160	906	212

Max Eff. % DR20 =	79
Max Eff. % DR10 =	79,5
Max Eff. % =	79,3
Max kW / St. DR20 =	18
Max kW / St. DR10 =	22,5
Max kW / St. =	27,5

Q (flow)	25%	50%	75%	100%
NPSH (m)	3,4	5	7,8	11,8

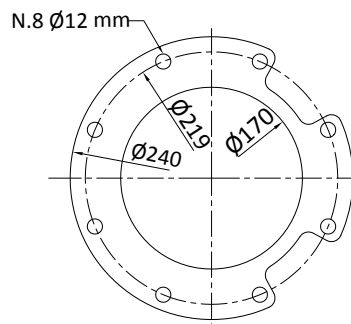
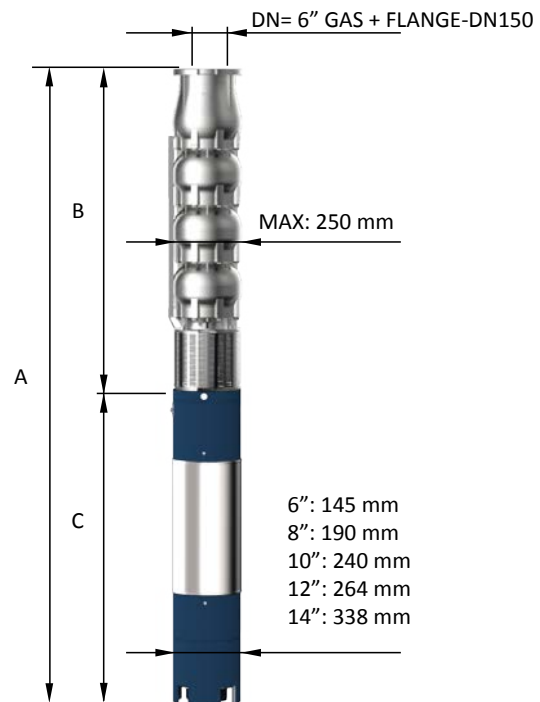

FOR COMMERCIAL TUBE  
EXTERNAL DIAMETER: 168,3 mm

# 10" 10LM 250

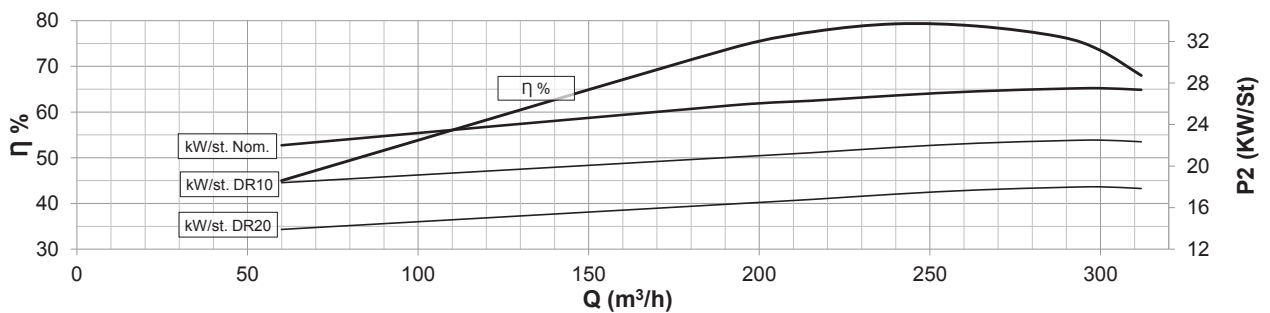
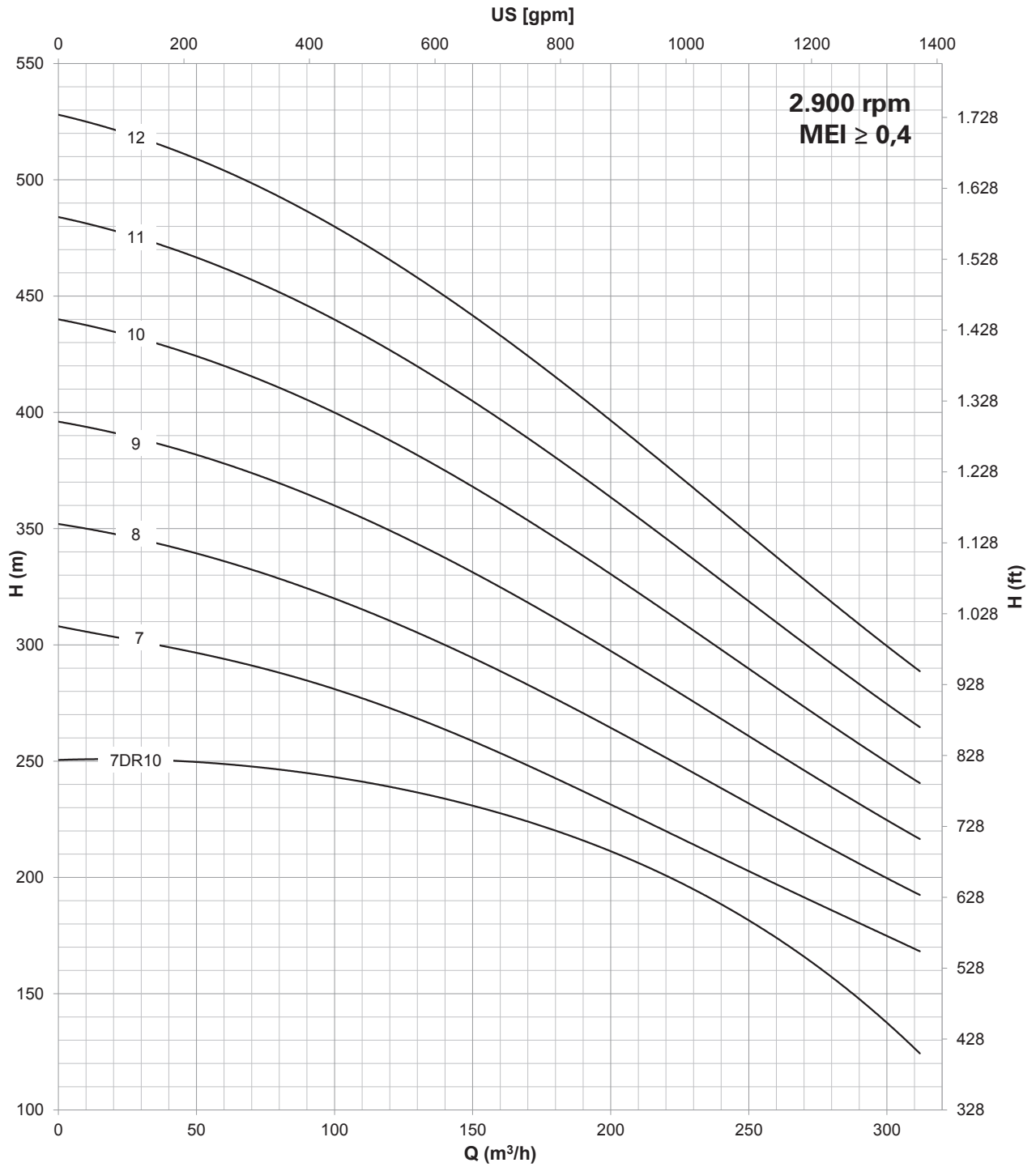

Compatibilità con acqua potabile DM 174 - Drinking water compatibility according DM 174  
 MEI ≥ 0,4 (direttiva EU No. 547/2012 - regulation EU N. 547/2012)  
 Per modelli con meno di 3 stadi ridurre l'eff. % del -5% / Models with less than 3 stages reduce the % eff. of 5%



# 10" 10LM 275

AISI 304 (LMS), AISI 316 (LMX), Duplex (LMD)

Motor 50 Hz - 2900 rpm				Q									
TYPE	Power		400 V A	l/min l/sec m <sup>3</sup> /h	0	1000	3400	3800	4200	4600	5000	5400	5800
	kW	HP			0	16,7	56,7	63,3	70,0	76,7	83,3	90,0	96,7
10LM 275/01 DR20	26	35	52,9	H[m]	36	36	28	26	25	23	21	19	16
10LM 275/01	37	50	75,8		45	44	37	35	34	32	30	28	25
10LM 275/02 DR20	55	75	106,2		72	71	56	52	50	46	42	39	32
10LM 275/02	66	90	126,0		90	87	73	70	67	63	60	56	50
10LM 275/03 DR10	92	125	175,1		122	121	97	92	88	82	77	72	62
10LM 275/03 D	110	150	211,0		135	131	110	105	101	95	90	85	75
10LM 275/04 DR10 D	130	175	245,3		163	161	130	123	118	110	103	96	83
10LM 275/04 D	150	200	277,2		180	175	146	140	134	126	120	113	100
10LM 275/05 DR10 D	150	200	277,2		204	202	162	154	147	137	129	120	104
10LM 275/05 D	165	225	313,3		225	219	183	175	168	158	150	141	125
10LM 275/06 DR10 D	185	250	342,2		245	242	194	185	176	164	155	144	125
10LM 275/06 D	220	300	430,0		270	262	220	210	202	190	180	169	150

Motor 50 Hz 2900 rpm	Dimensions (mm)			Weight (kg)	
TYPE	A	B	C	M	P
10LM 275/01 DR20	1806	625	1181	100	41
10LM 275/01	1966	625	1341	118	41
10LM 275/02 DR20	2038	805	1233	200	56
10LM 275/02	2107	805	1302	214	56
10LM 275/03 DR10	2568	985	1583	270	72
10LM 275/03 D	2718	985	1733	300	72
10LM 275/04 DR10 D	2799	1165	1634	385	87
10LM 275/04 D	2899	1165	1734	415	87
10LM 275/05 DR10 D	3079	1345	1734	415	103
10LM 275/05 D	3199	1345	1854	444	103
10LM 275/06 DR10 D	3509	1525	1984	480	118
10LM 275/06 D	3635	1525	2110	700	118

Max Eff. % DR20 =	76,1
Max Eff. % DR10 =	77,2
Max Eff. % =	76,5
Max kW / St. DR20 =	25
Max kW / St. DR10 =	29
Max kW / St. =	33

Q (flow)	25%	50%	75%	100%
NPSH (m)	3,4	5	7,8	11,8

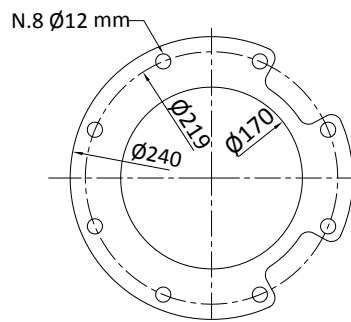
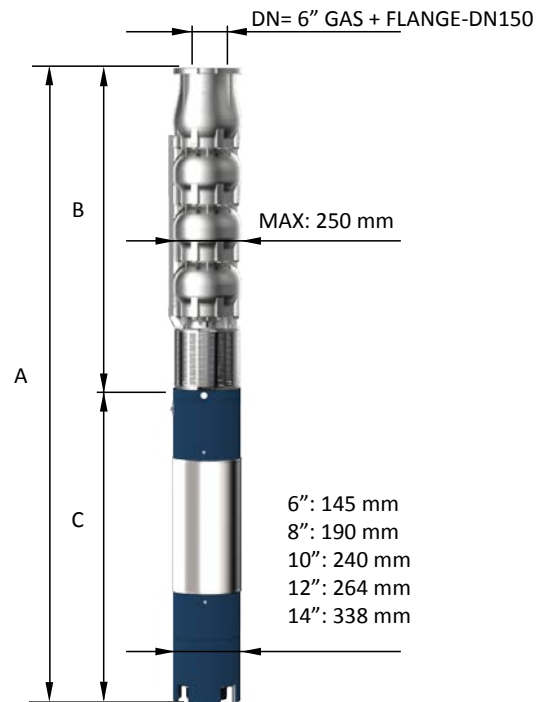

FOR COMMERCIAL TUBE  
EXTERNAL DIAMETER: 168,3 mm

# 10" 10LM 275

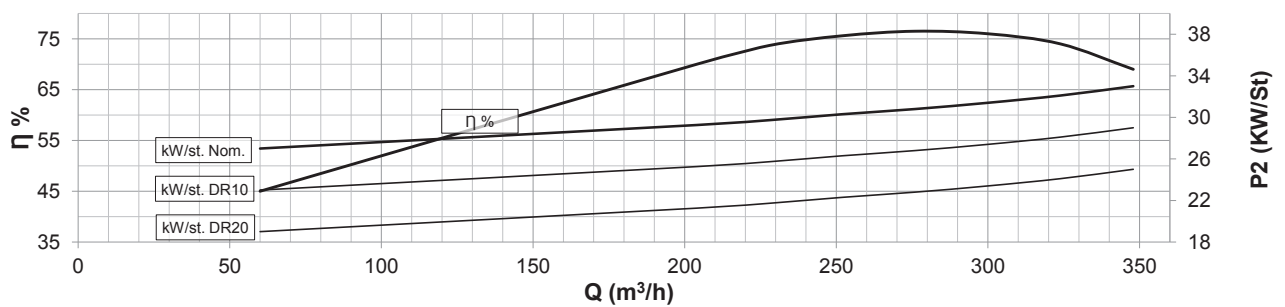
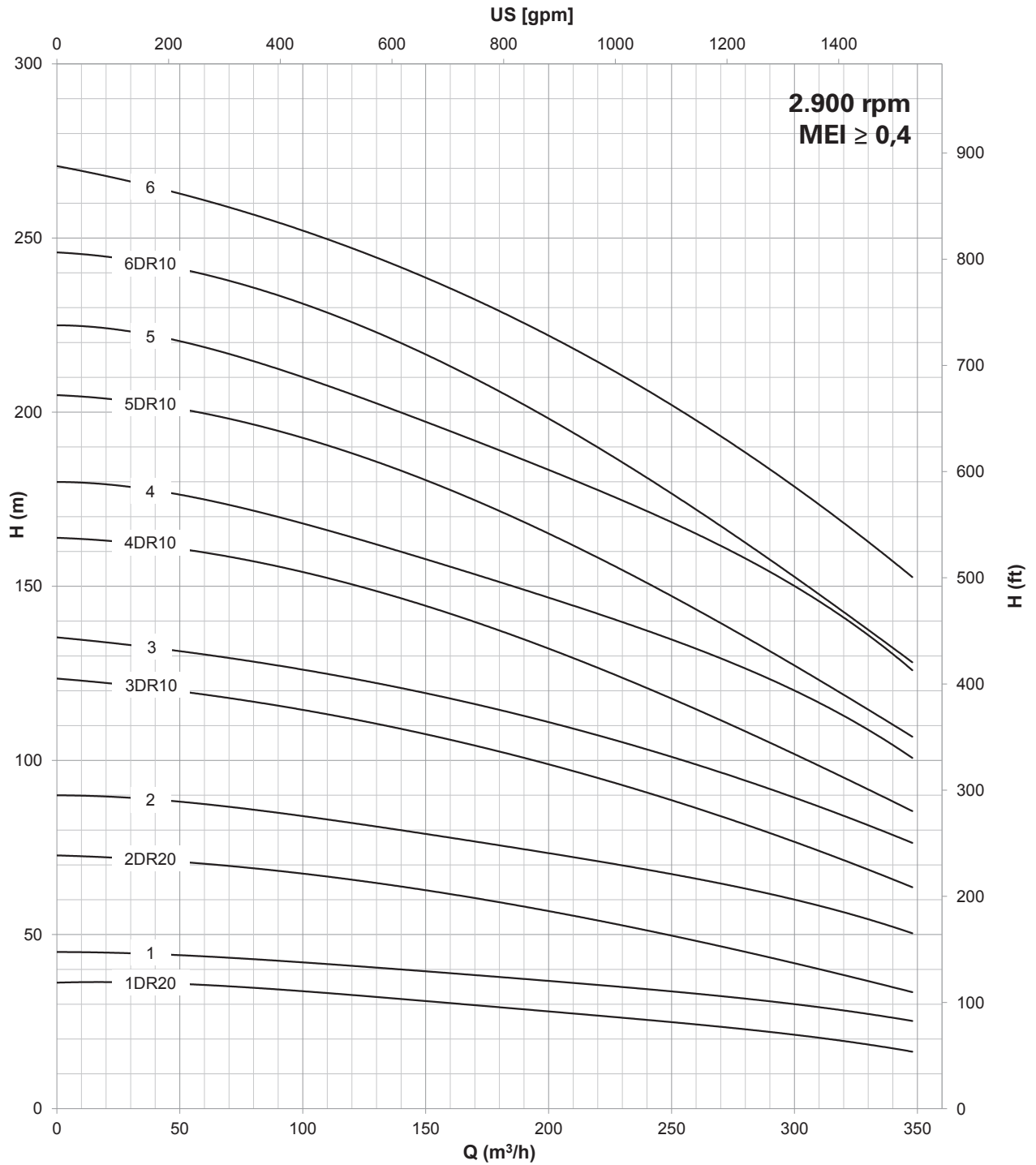

Compatibilità con acqua potabile DM 174 - Drinking water compatibility according DM 174  
 MEI ≥ 0,4 (direttiva EU No. 547/2012 - regulation EU N. 547/2012)  
 Per modelli con meno di 3 stadi ridurre l'eff. % del -5% / Models with less than 3 stages reduce the % eff. of 5%



# 10" 10LM 275

AISI 304 (LMS), AISI 316 (LMX), Duplex (LMD)

Motor 50 Hz - 2900 rpm				Q									
TYPE	Power		400 V A	l/min l/sec m <sup>3</sup> /h	0	1000	3400	3800	4200	4600	5000	5400	5800
	kW	HP			0	16,7	56,7	63,3	70,0	76,7	83,3	90,0	96,7
10LM 275/07 DR10 D	220	300	430,0	H[m]	286	282	227	216	206	192	181	168	146
10LM 275/07 D	250	340	481,0		315	306	256	245	235	221	210	197	175
10LM 275/08 D	300	400	551,0		360	350	293	280	269	253	240	226	200
10LM 275/09 D	300	400	551,0		405	393	329	315	302	284	270	254	225
10LM 275/10 D	330	450	620,0		450	437	366	350	336	316	300	282	250
10LM 275/11 D	370	500	693,0		495	481	403	385	370	348	330	310	275
10LM 275/12 D	400	550	798,0		540	524	439	420	403	379	360	338	300

Motor 50 Hz 2900 rpm	Dimensions (mm)			Weight (kg)	
TYPE	A	B	C	M	P
10LM 275/07 DR10 D	3815	1705	2110	700	134
10LM 275/07 D	3985	1705	2280	775	134
10LM 275/08 D	4165	1885	2280	775	149
10LM 275/09 D	4345	2065	2280	775	165
10LM 275/10 D	4405	2245	2160	906	180
10LM 275/11 D	4585	2425	2160	906	196
10LM 275/12 D	4925	2605	2320	1010	211

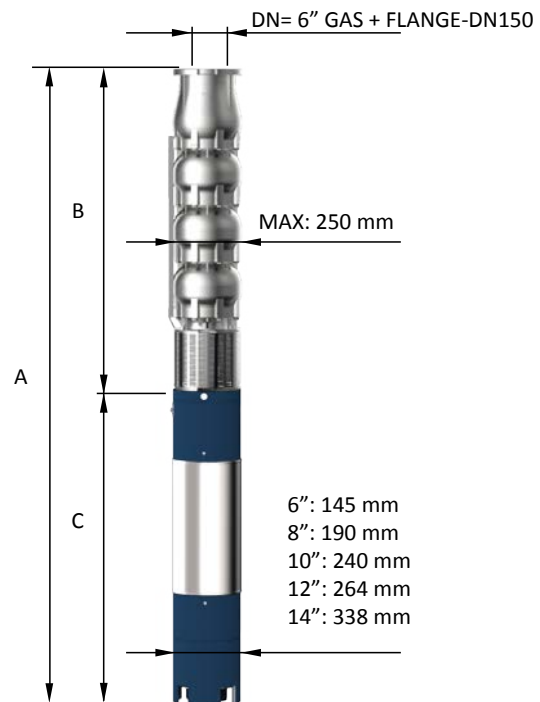

Max Eff. % DR20 =	76,1
Max Eff. % DR10 =	77,2
Max Eff. % =	76,5
Max kW / St. DR20 =	25
Max kW / St. DR10 =	29
Max kW / St. =	33

Q (flow)	25%	50%	75%	100%
NPSH (m)	3,4	5	7,8	11,8

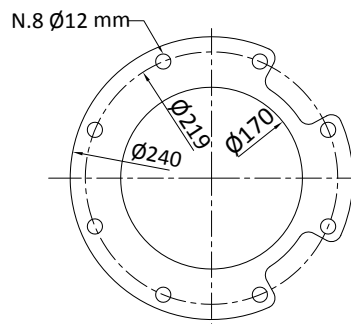

FOR COMMERCIAL TUBE  
EXTERNAL DIAMETER: 168,3 mm



# 10" 10LM 275

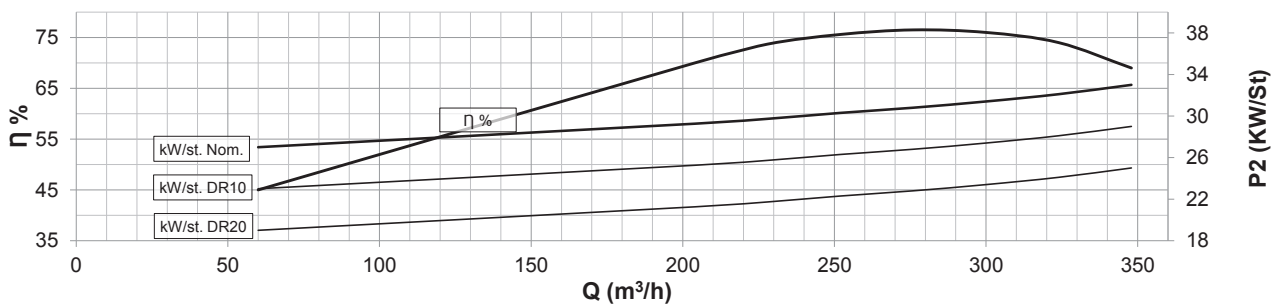
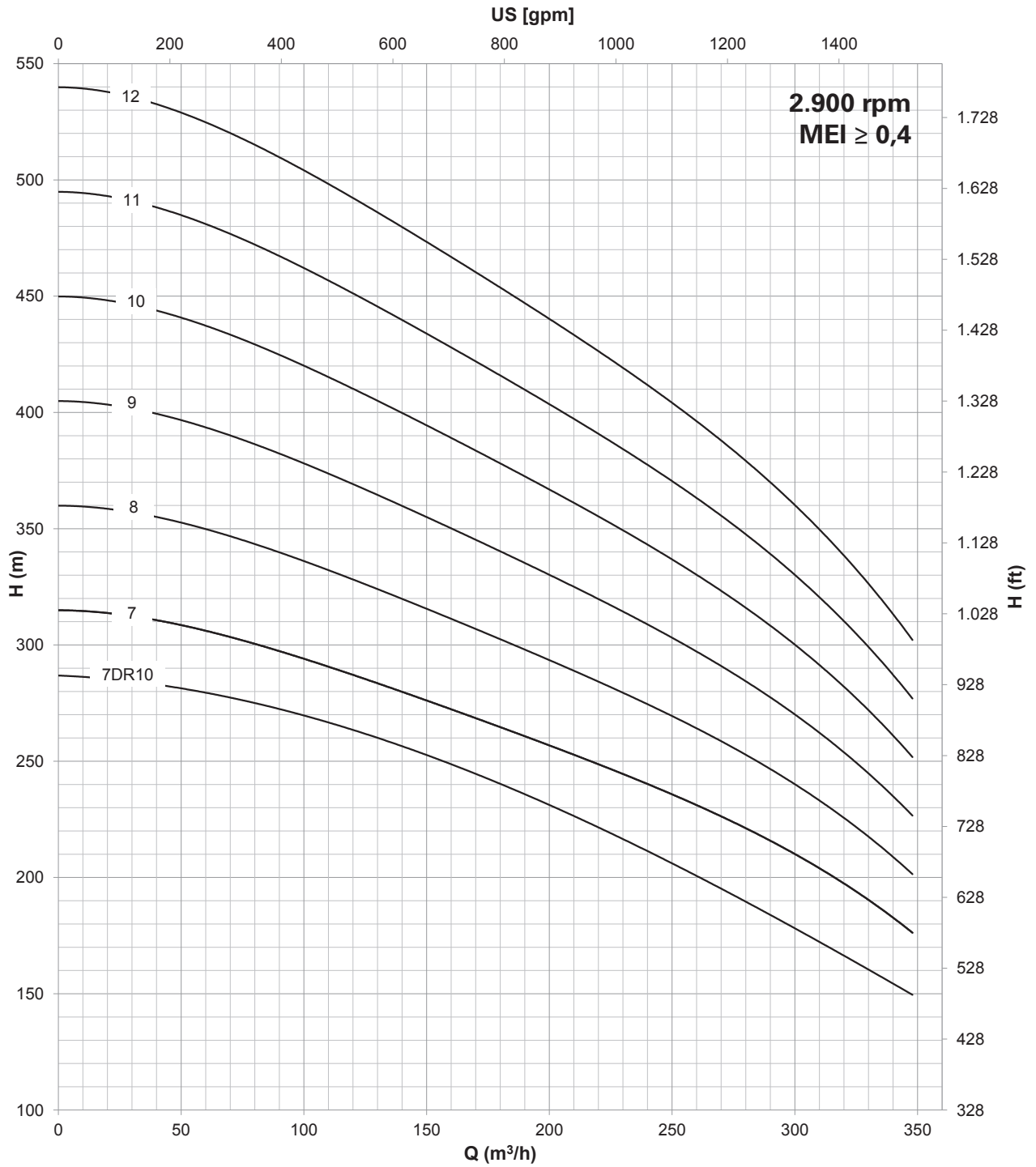

Compatibilità con acqua potabile DM 174 - Drinking water compatibility according DM 174  
 MEI ≥ 0,4 (direttiva EU No. 547/2012 - regulation EU N. 547/2012)  
 Per modelli con meno di 3 stadi ridurre l'eff. % del -5% / Models with less than 3 stages reduce the % eff. of 5%



# 12" 12LM 360

AISI 304 (LMS), AISI 316 (LMX), Duplex (LMD)

Motor 50 Hz - 2900 rpm				Q									
TYPE	Power		400 V A	l/min l/sec m <sup>3</sup> /h	0	1500	4000	4500	5000	5500	6000	6500	7000
	kW	HP			0	25,0	66,7	75,0	83,3	91,7	100,0	108,3	116,7
					0	90	240	270	300	330	360	390	420
12LM 360/01 DR35	37	50	75,8	H[m]	41	40	37	35	33	32	29		
12LM 360/01 DR20	55	75	106,2		49	48	47	45	44	42	40	38	34
12LM 360/01	66	90	126,0		62	61	55	53	52	52	50	47	42
12LM 360/02 DR35	75	100	143,2		82	80	73	70	66	63	57		
12LM 360/02 DR20 D	110	150	211,0		98	96	93	90	87	84	80	75	68
12LM 360/02 D	130	175	245,3		124	122	109	106	104	103	100	93	84
12LM 360/03 DR20 D	150	200	277,2		147	144	140	135	131	126	120	113	102
12LM 360/03 DR10 D	185	250	342,2		165	162	152	149	144	140	132	126	120
12LM 360/03 D	220	300	430,0		186	183	164	159	156	155	150	140	126
12LM 360/04 DR20 D	220	300	430,0		196	192	186	180	174	168	160	150	136
12LM 360/04 DR10 D	250	340	481,0		220	216	202	198	192	186	176	168	160
12LM 360/04 D	300	400	551,0		248	244	218	212	208	206	200	186	168

Motor 50 Hz 2900 rpm	Dimensions (mm)			Weight (kg)	
TYPE	A	B	C	M	P
12LM 360/01 DR35	2111	770	1341	118	79
12LM 360/01 DR20	2003	770	1233	200	79
12LM 360/01	2072	770	1302	214	79
12LM 360/02 DR35	2383	1000	1383	230	104
12LM 360/02 DR20 D	2733	1000	1733	300	104
12LM 360/02 D	2634	1000	1634	385	104
12LM 360/03 DR20 D	2964	1230	1734	415	129
12LM 360/03 DR10 D	3214	1230	1984	480	129
12LM 360/03 D	3340	1230	2110	700	129
12LM 360/04 DR20 D	3570	1460	2110	700	154
12LM 360/04 DR10 D	3740	1460	2280	775	154
12LM 360/04 D	3740	1460	2280	775	154

Max Eff. % DR35 =	77,5
Max Eff. % DR20 =	80
Max Eff. % DR10 =	80,5
Max Eff. % =	81
Max kW / St. DR35 =	36,80
Max kW / St. DR20 =	49,5
Max kW / St. DR10 =	55,2
Max kW / St. =	64,2

Q (flow)	25%	50%	75%	100%
NPSH (m)	3,4	5	7,8	11,8

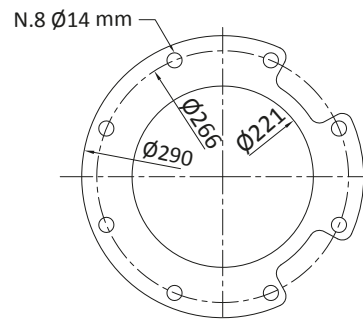
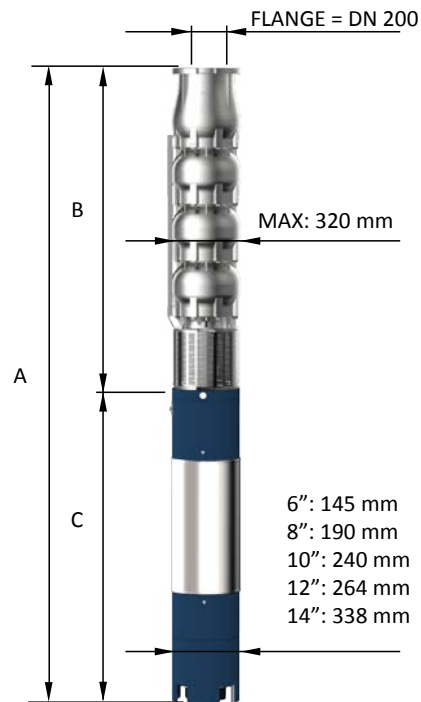

FOR COMMERCIAL TUBE  
EXTERNAL DIAMETER: 219,1 mm

# 12" 12LM 360

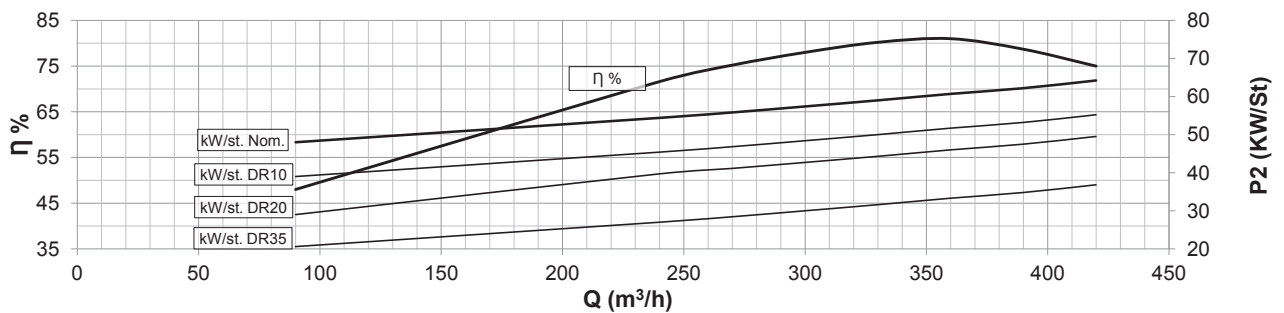
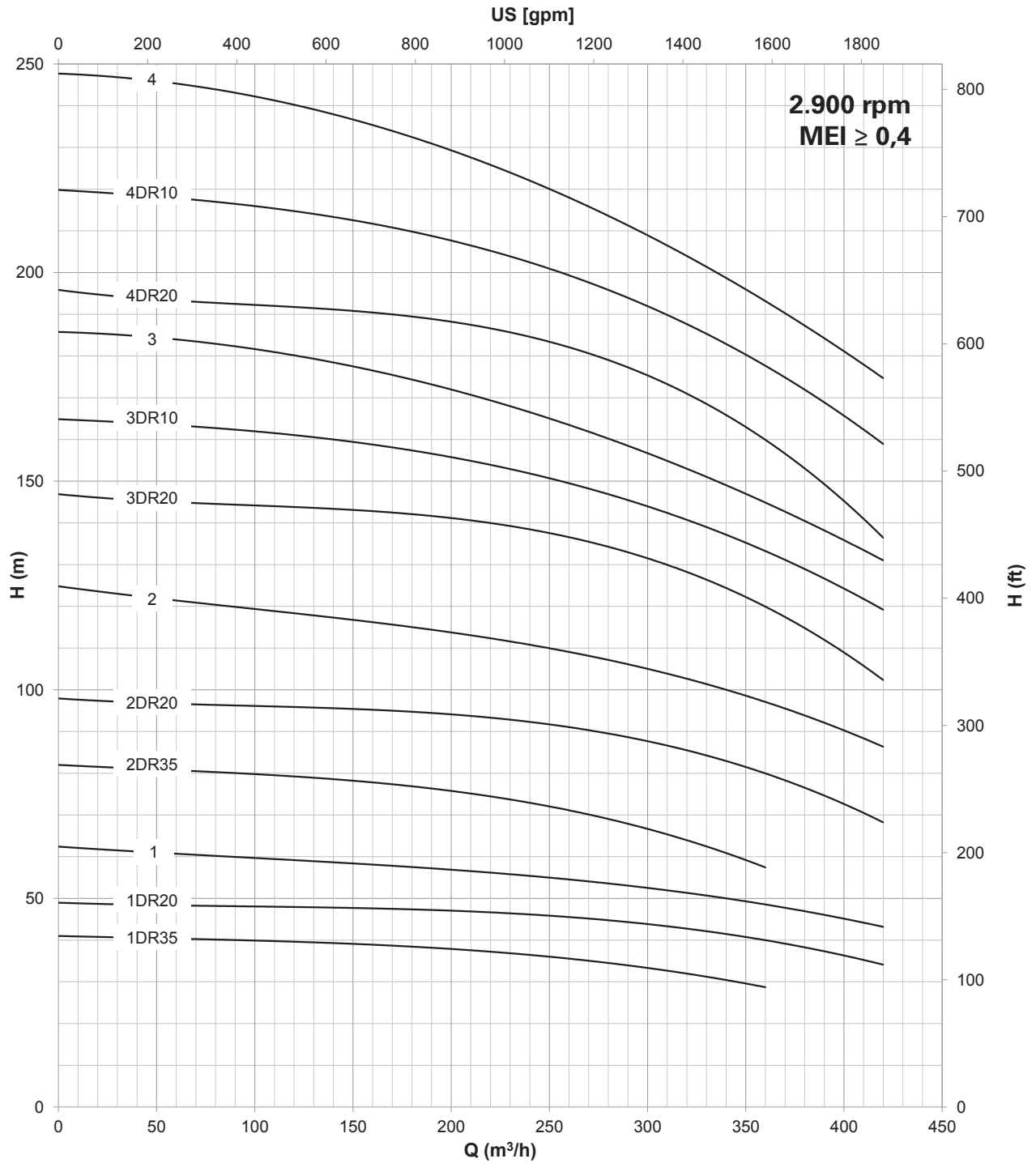

Compatibilità con acqua potabile DM 174 - Drinking water compatibility according DM 174  
 MEI ≥ 0,4 (direttiva EU No. 547/2012 - regulation EU N. 547/2012)  
 Per modelli con meno di 3 stadi ridurre l'eff. % del -5% / Models with less than 3 stages reduce the % eff. of 5%



# 12" 12LM 360

AISI 304 (LMS), AISI 316 (LMX), Duplex (LMD)

Motor 50 Hz - 2900 rpm				Q									
TYPE	Power		400 V A	l/min l/sec m <sup>3</sup> /h	0	1500	4000	4500	5000	5500	6000	6500	7000
	kW	HP			0	25,0	66,7	75,0	83,3	91,7	100,0	108,3	116,7
12LM 360/05 DR20 D	250	340	481,0	H[m]	245	240	233	225	218	210	200	188	170
12LM 360/05 DR10 D	300	400	551,0		275	270	253	248	240	233	220	210	200
12LM 360/05 D	330	450	620,0		310	305	273	265	260	258	250	233	210
12LM 360/06 DR10 D	370	500	693,0		330	324	304	298	288	280	264	252	240
12LM 360/06 D	400	550	798,0		372	366	328	318	312	310	300	280	252
12LM 360/07 DR10 D	400	550	798,0		385	378	354	347	336	326	308	294	280

Motor 50 Hz 2900 rpm	Dimensions (mm)			Weight (kg)	
TYPE	A	B	C	M	P
12LM 360/05 DR20 D	3970	1690	2280	775	179
12LM 360/05 DR10 D	3970	1690	2280	775	179
12LM 360/05 D	3850	1690	2160	906	179
12LM 360/06 DR10 D	4240	1920	2320	1010	204
12LM 360/06 D	4380	1920	2460	1105	204
12LM 360/07 DR10 D	4610	2150	2460	1105	229

Max Eff. % DR35 =	77,5
Max Eff. % DR20 =	80
Max Eff. % DR10 =	80,5
Max Eff. % =	81
Max kW / St. DR35 =	36,80
Max kW / St. DR20 =	49,5
Max kW / St. DR10 =	55,2
Max kW / St. =	64,2

Q (flow)	25%	50%	75%	100%
NPSH (m)	3,4	5	7,8	11,8

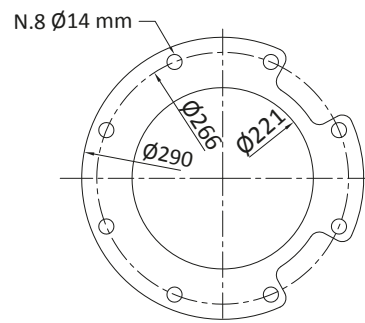
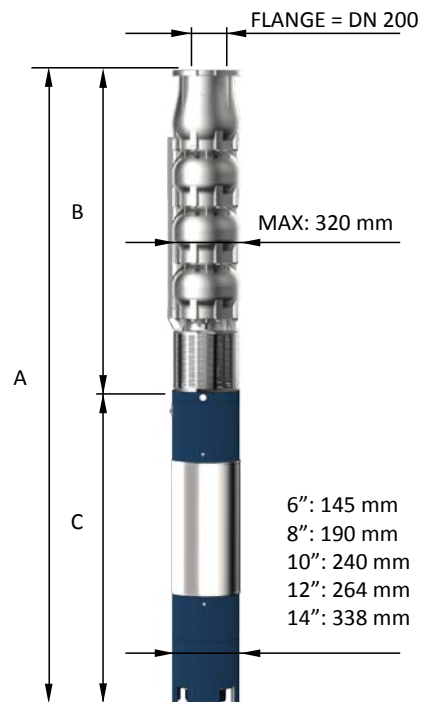

FOR COMMERCIAL TUBE  
EXTERNAL DIAMETER: 219,1 mm

# 12" 12LM 360

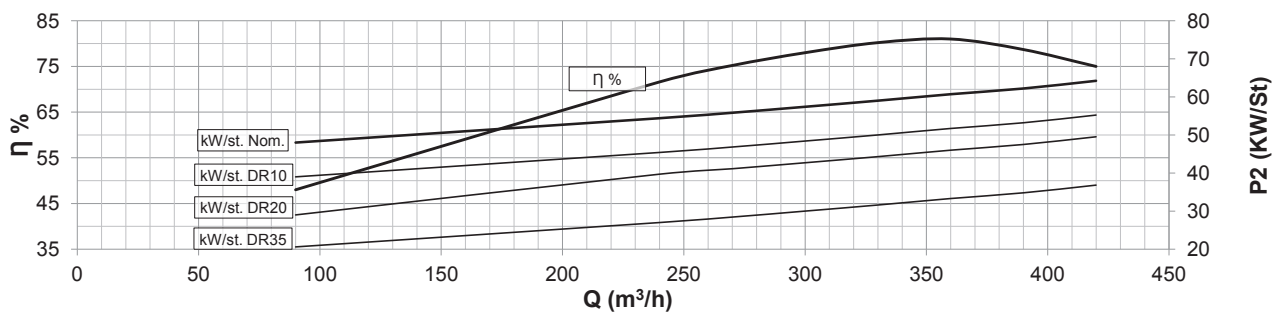
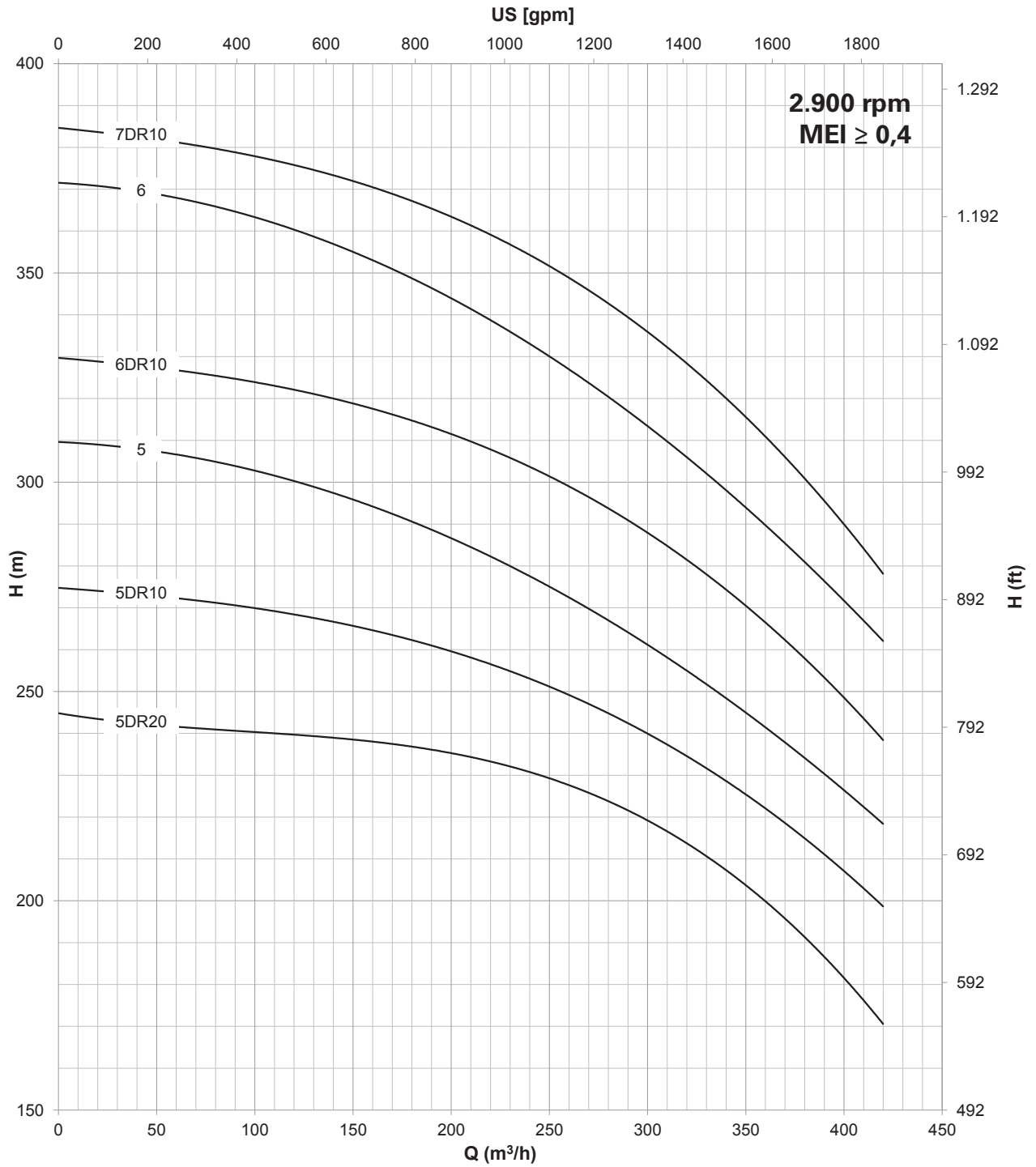

Compatibilità con acqua potabile DM 174 - Drinking water compatibility according DM 174  
 MEI ≥ 0,4 (direttiva EU No. 547/2012 - regulation EU N. 547/2012)  
 Per modelli con meno di 3 stadi ridurre l'eff. % del -5% / Models with less than 3 stages reduce the % eff. of 5%



# 12" 12LM 400

AISI 304 (LMS), AISI 316 (LMX), Duplex (LMD)

Motor 50 Hz - 2900 rpm				Q									
TYPE	Power		400 V A	l/min l/sec m³/h	0	2000	6000	6500	7000	7500	8000	8500	9000
	kW	HP			0	33,3	100,0	108,3	116,7	125,0	133,3	141,7	150,0
					0	120	360	390	420	450	480	510	540
12LM 400/01 DR30	37	50	75,8	H[m]	43	42	32	30	27	24			
12LM 400/01 DR20	55	75	106,2		47	45	37	35	33	30	26	22	
12LM 400/01 DR10	55	75	106,2		53	52	42	40	38	36	32	28	
12LM 400/01	66	90	126,0		58	57	46	44	42	40	37	31	27
12LM 400/02 DR30	75	100	143,2		86	84	64	59	54	48			
12LM 400/02 DR20	92	125	175,1		94	90	73	69	65	59	52	44	
12LM 400/02 DR10 D	110	150	211,0		106	104	84	80	76	71	64	56	
12LM 400/02 D	130	175	245,3		116	114	92	88	84	80	73	62	54
12LM 400/03 DR20 D	150	200	277,2		141	135	110	104	98	89	78	66	
12LM 400/03 DR10 D	165	225	313,3		159	156	126	120	114	107	96	84	
12LM 400/03 D	185	250	342,2		174	171	138	132	126	120	110	93	81

Motor 50 Hz 2900 rpm	Dimensions (mm)			Weight (kg)	
TYPE	A	B	C	M	P
12LM 400/01 DR30	2111	770	1341	118	79
12LM 400/01 DR20	2003	770	1233	200	79
12LM 400/01 DR10	2003	770	1233	200	79
12LM 400/01	2072	770	1302	214	79
12LM 400/02 DR30	2383	1000	1383	230	104
12LM 400/02 DR20	2583	1000	1583	270	104
12LM 400/02 DR10 D	2733	1000	1733	300	104
12LM 400/02 D	2634	1000	1634	385	104
12LM 400/03 DR20 D	2964	1230	1734	415	129
12LM 400/03 DR10 D	3084	1230	1854	444	129
12LM 400/03 D	3214	1230	1984	480	129

Max Eff. % DR30 =	81,2
Max Eff. % DR20 =	81,8
Max Eff. % DR10 =	82,7
Max Eff. % =	81,6
Max Eff. % A =	82,5
Max kW / St. DR30 =	37
Max kW / St. DR20 =	45,6
Max kW / St. DR10 =	53
Max kW / St. =	60,4
Max kW / St. A =	67

Q (flow)	25%	50%	75%	100%
NPSH (m)	3,4	5	7,8	11,8

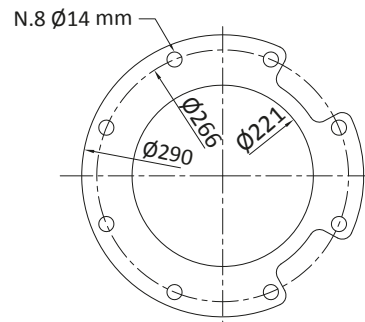
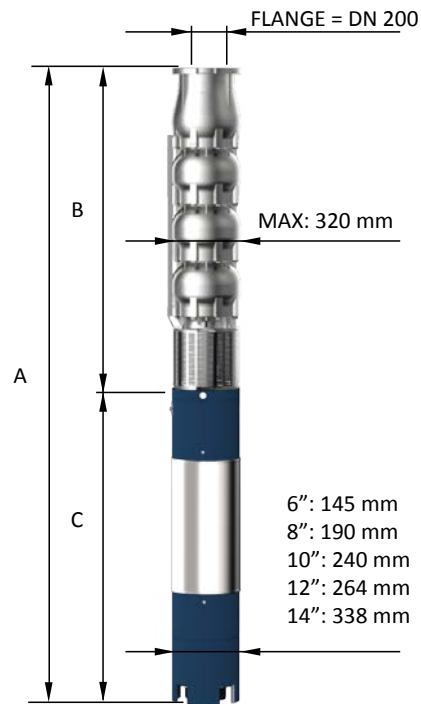

FOR COMMERCIAL TUBE  
EXTERNAL DIAMETER: 219,1 mm

# 12" 12LM 400

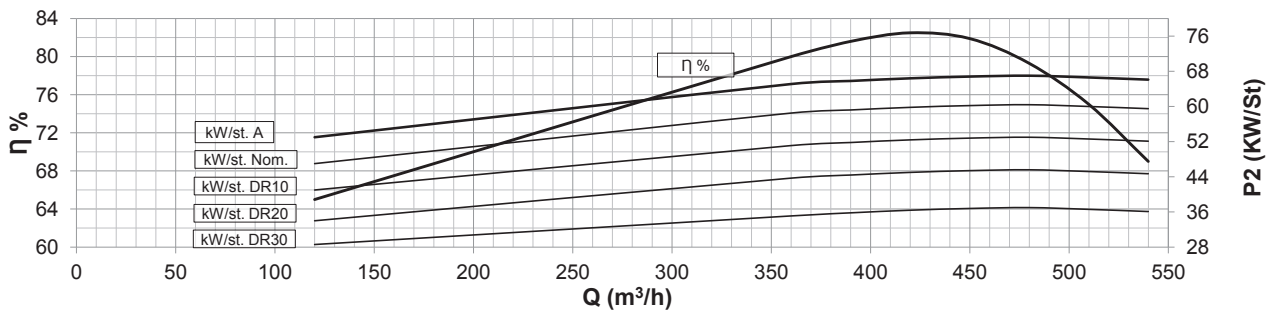
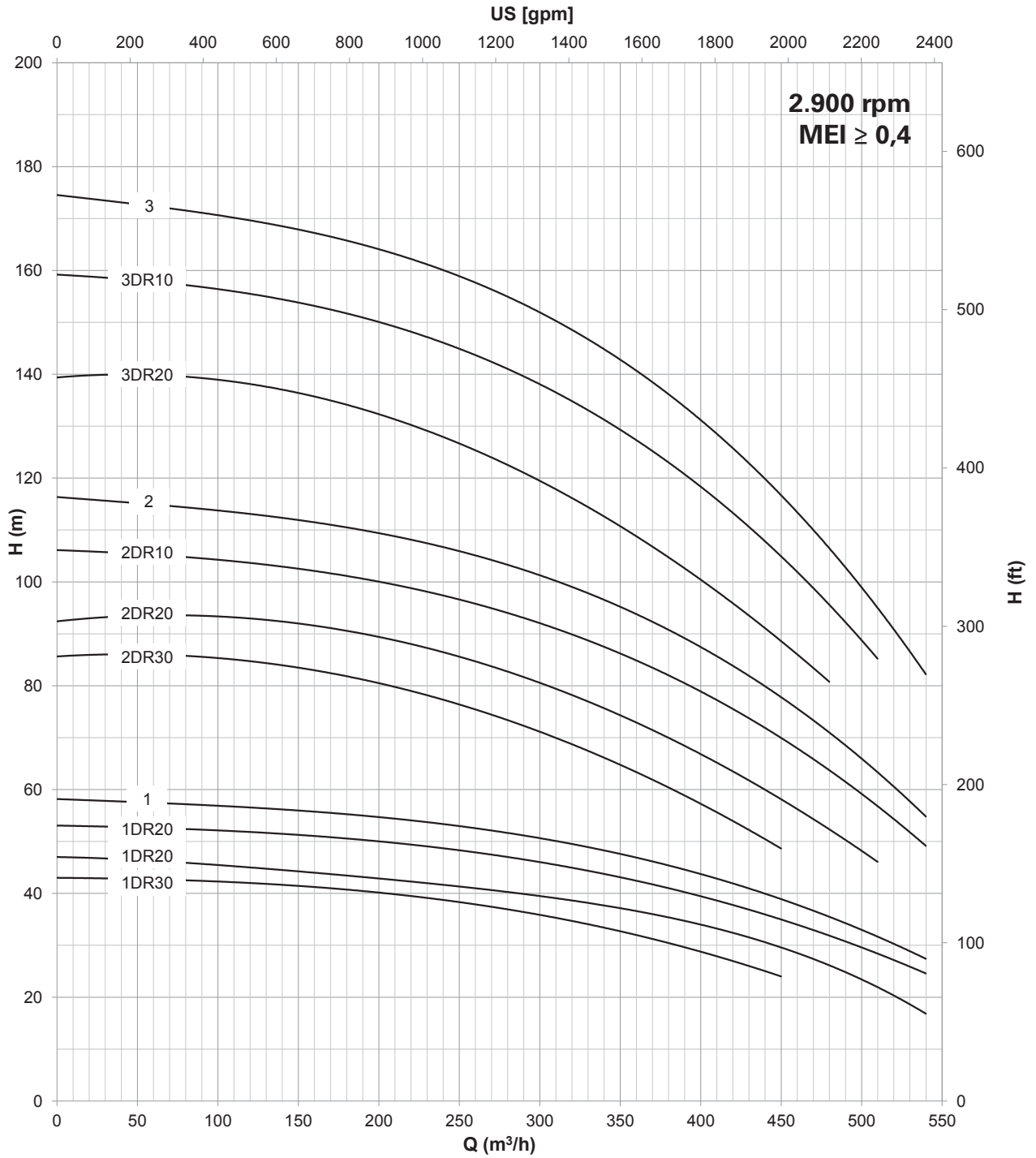

Compatibilità con acqua potabile DM 174 - Drinking water compatibility according DM 174  
MEI ≥ 0,4 (direttiva EU No. 547/2012 - regulation EU N. 547/2012)  
Per modelli con meno di 3 stadi ridurre l'eff. % del -5% / Models with less than 3 stages reduce the % eff. of 5%

# 12" 12LM 400

AISI 304 (LMS), AISI 316 (LMX), Duplex (LMD)

Motor 50 Hz - 2900 rpm				Q									
TYPE	Power		400 V A	l/min l/sec m <sup>3</sup> /h	0	2000	6000	6500	7000	7500	8000	8500	9000
	kW	HP			0	33,3	100,0	108,3	116,7	125,0	133,3	141,7	150,0
12LM 400/04 DR20 D	185	250	342,2	H[m]	188	180	146	138	130	118	104	88	
12LM 400/04 DR10 D	220	300	430,0		212	208	168	160	152	142	128	112	
12LM 400/04 D	250	340	481,0		232	228	184	176	168	160	146	124	108
12LM 400/05 DR10 D	300	400	551,0		265	260	210	200	190	178	160	140	
12LM 400/05 D	330	450	620,0		290	285	230	220	210	200	183	155	135
12LM 400/05A D	370	500	693,0		305	300	250	240	230	223	205	195	160
12LM 400/06 D	370	500	693,0		348	342	276	264	252	240	220	186	162

Motor 50 Hz 2900 rpm	Dimensions (mm)			Weight (kg)	
TYPE	A	B	C	M	P
12LM 400/04 DR20 D	3444	1460	1984	480	154
12LM 400/04 DR10 D	3570	1460	2110	700	154
12LM 400/04 D	3740	1460	2280	775	154
12LM 400/05 DR10 D	3970	1690	2280	775	179
12LM 400/05 D	3850	1690	2160	906	179
12LM 400/05A D	4010	1690	2320	1010	179
12LM 400/06 D	4240	1920	2320	1010	204

Max Eff. % DR30 =	81,2
Max Eff. % DR20 =	81,8
Max Eff. % DR10 =	82,7
Max Eff. % =	81,6
Max Eff. % A =	82,5
Max kW / St. DR30 =	37
Max kW / St. DR20 =	45,6
Max kW / St. DR10 =	53
Max kW / St. =	60,4
Max kW / St. A =	67

Q (flow)	25%	50%	75%	100%
NPSH (m)	3,4	5	7,8	11,8

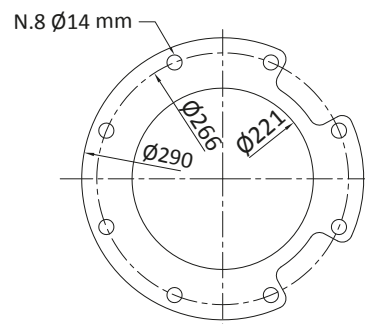
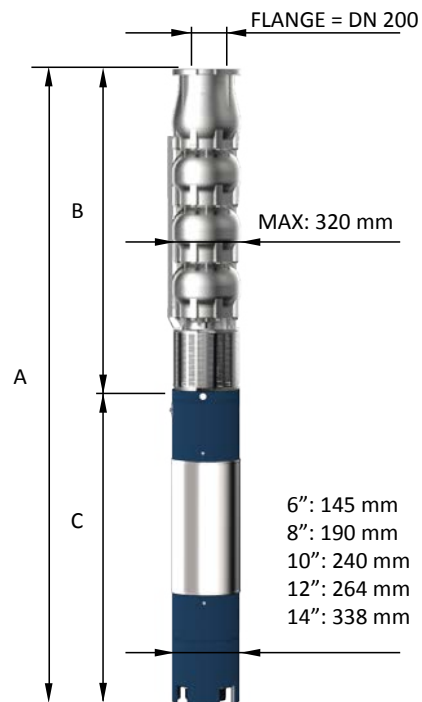

FOR COMMERCIAL TUBE  
EXTERNAL DIAMETER: 219,1 mm



# 12" 12LM 400

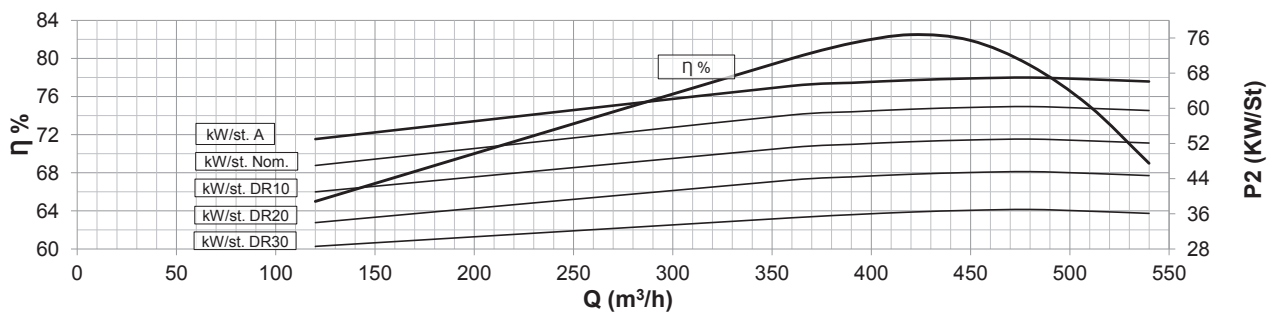
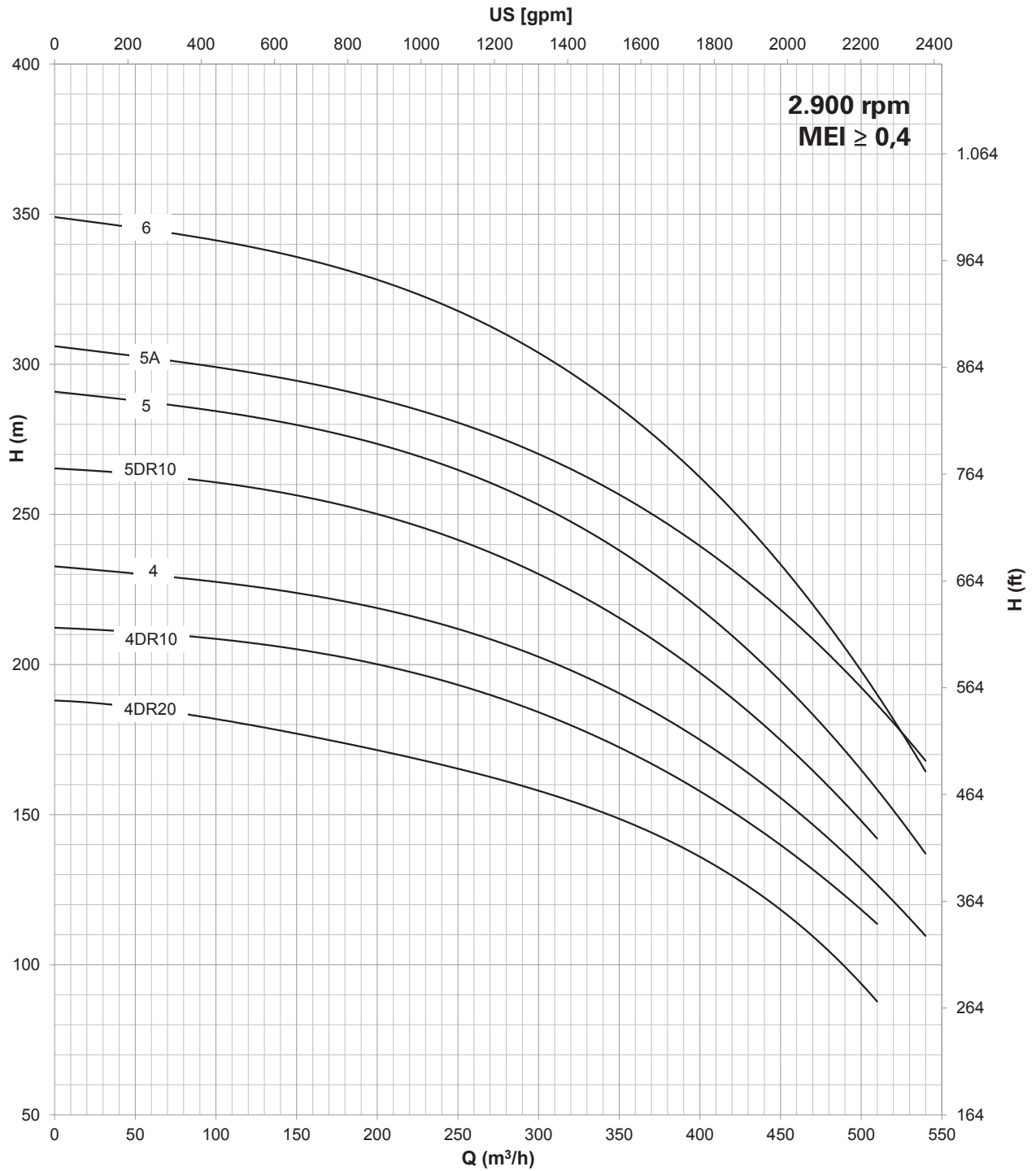

Compatibilità con acqua potabile DM 174 - Drinking water compatibility according DM 174  
 MEI ≥ 0,4 (direttiva EU No. 547/2012 - regulation EU N. 547/2012)  
 Per modelli con meno di 3 stadi ridurre l'eff. % del -5% / Models with less than 3 stages reduce the % eff. of 5%



Motor 50 Hz - 2900 rpm				Q									
TYPE	Power		400 V	I/min	0	1333	2667	4000	5333	6667	8000	8500	9667
	kW	HP		A	I/sec	0	22,2	44,5	66,7	88,9	111,1	133,3	141,8
					m <sup>3</sup> /h	0	80	160	240	320	400	480	510
E 14 A/1 D	66	90	126,0	H[m]	71,8	66,5	62,5	58,7	54,4	49,0	41,6	38,2	
E 14 A/1 C	75	100	143,2		76,8	71,7	67,5	63,8	59,6	54,6	47,9	45,0	39,0
E 14 A/1 B	92	125	175,1		85,1	79,9	75,6	71,8	67,8	63,3	57,7	55,1	48,2
E 14 A/1 A	110	150	211,0		97,1	90,8	85,5	80,4	75,6	70,7	65,4	63,0	57,6
E 14 A/1 Nom.	130	175	245,3		108,6	99,3	92,3	87,0	82,5	78,0	73,0	70,8	64,1
E 14 A/2 D	130	175	245,3		143,5	133,0	125,0	117,4	108,8	98,0	83,2	76,4	
E 14 A/2 C	150	200	277,2		153,6	143,4	135,0	127,6	119,1	109,1	95,8	90,0	78,0
E 14 A/2 B	185	250	342,2		170,2	159,8	151,2	143,6	135,6	126,5	115,4	110,2	96,4
E 14 A/2 A	220	300	430,0		194,3	181,6	171,0	160,8	151,2	141,4	130,8	126,0	115,2
E 14 A/2 Nom.	250	340	481,0		217,3	198,6	184,6	174,0	165,0	156,0	146,0	141,6	128,2

Motor 50 Hz 2900 rpm	Dimensions (mm)			Weight (kg)	
TYPE	A	B	C	M	P
E 14 A/1 D	2237	935	1302	214	184
E 14 A/1 C	2318	935	1383	230	184
E 14 A/1 B	2518	935	1583	270	184
E 14 A/1 A	2668	935	1733	300	184
E 14 A/1 Nom.	2569	935	1634	385	184
E 14 A/2 D	2809	1175	1634	385	260
E 14 A/2 C	2909	1175	1734	415	260
E 14 A/2 B	3159	1175	1984	480	260
E 14 A/2 A	3285	1175	2110	700	260
E 14 A/2 Nom.	3455	1175	2280	775	260

Max Eff. % =	82,3
Max KW / St.: D = - D.230mm =	64,9
Max KW / St.: C = - D.238mm =	74,0
Max KW / St.: B = - D.251mm =	90,8
Max KW / St. A = - D.268mm =	109,1
Max KW / St. Nom. - D.276mm =	119,3

Q (flow)	25%	50%	75%	100%
NPSH (m)	5,8	6,4	9,4	15,3

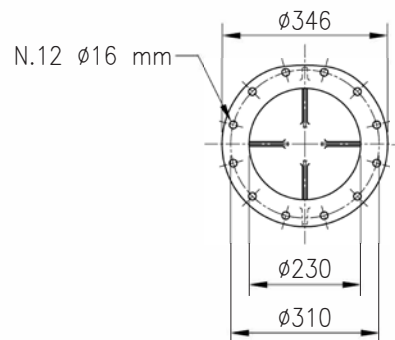
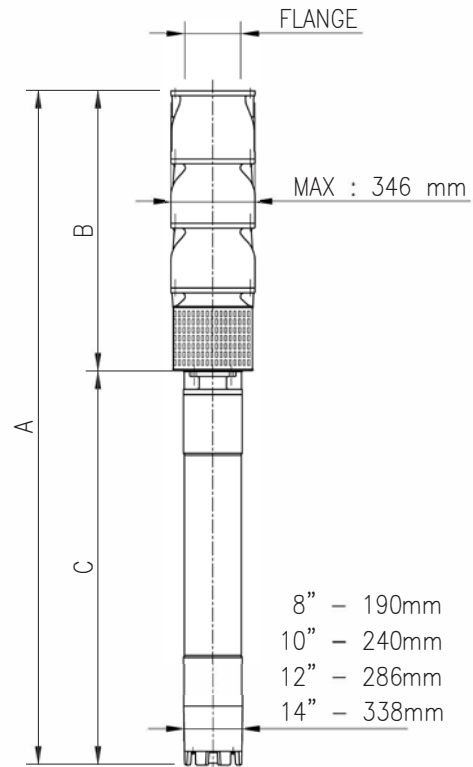

# 14" E14A

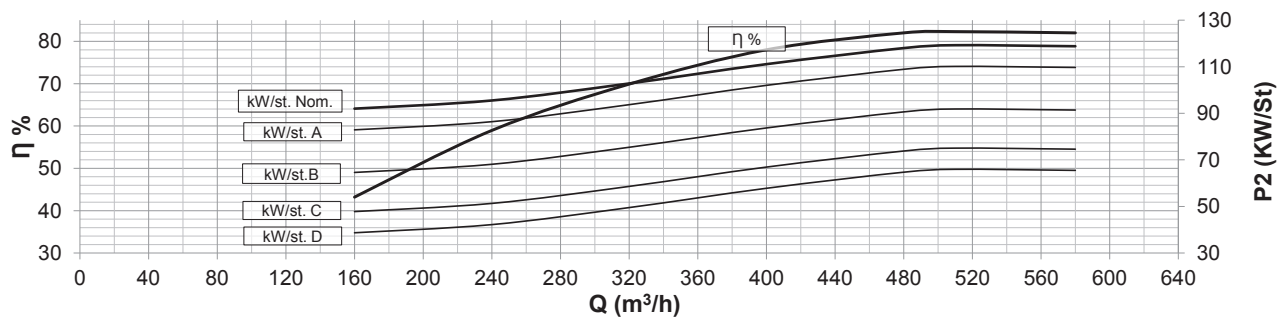
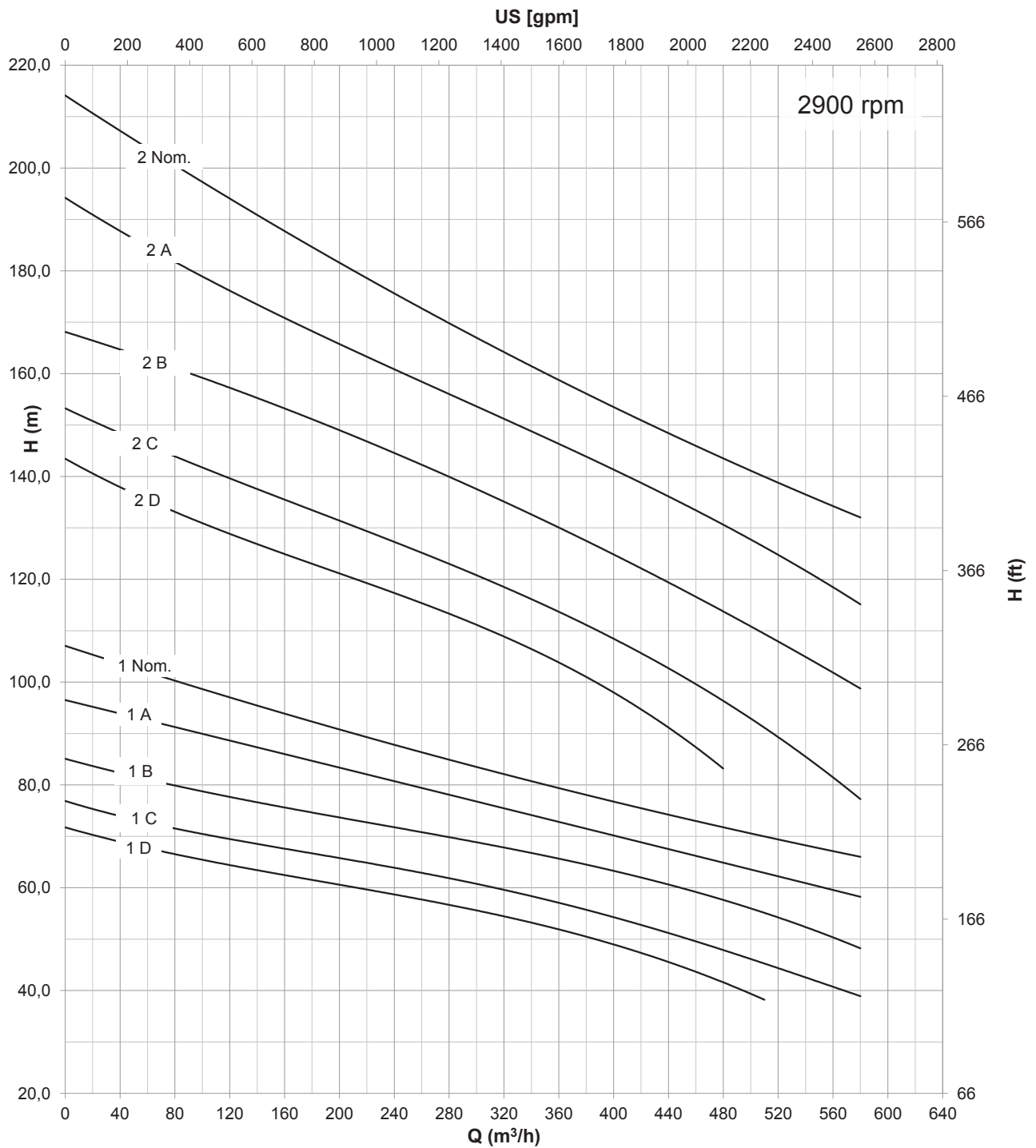

Compatibilità con acqua potabile DM 174 - Drinking water compatibility according DM 174  
 MEI ≥ 0,4 (direttiva EU No. 547/2012 - regulation EU N. 547/2012)  
 Per modelli con meno di 3 stadi ridurre l'eff. % del -5% / Models with less than 3 stages reduce the % eff. of 5%



# 14" E14B Cast iron (E), AISI 316 (EX), Duplex (ED)

Motor 50 Hz - 2900 rpm				Q									
TYPE	Power		400 V	I/min	0	1333	4000	5333	6667	9000	10000	12500	14333
	kW	HP		A	I/sec	0	22,2	66,7	88,9	111,1	150,0	166,7	208,3
					m³/h	0	80	240	320	400	540	600	750
E 14 B/1 C	92	125	175,1	H[m]	73,5	72,5	68,0	63,5	57,8	44,0	36,5	14,0	
E 14 B/1 B	110	150	211,0		80,4	79,5	75,0	71,5	66,0	53,5	46,7	26,5	
E 14 B/1 A	130	175	245,3		87,0	84,0	79,0	77,0	73,8	66,0	61,5	45,5	29,0
E 14 B/1 Nom.	150	200	277,2		100,8	97,4	90,4	86,9	82,9	74,2	69,0	53,9	38,4
E 14 B/2 C	185	250	342,2		147,0	145,0	136,0	127,0	115,6	88,0	73,0	28,0	
E 14 B/2 B	220	300	430,0		160,7	159,0	150,0	143,0	132,0	107,0	93,4	53,0	
E 14 B/2 A	300	400	551,0		174,0	168,0	158,0	154,0	147,6	132,0	123,0	91,0	58,0
E 14 B/2 Nom.	300	400	551,0		201,6	194,8	180,8	173,8	165,8	148,4	138,0	107,8	76,8

Motor 50 Hz 2900 rpm	Dimensions (mm)			Weight (kg)	
TYPE	A	B	C	M	P
E 14 B/1 C	2488	905	1583	270	184
E 14 B/1 B	2638	905	1733	300	184
E 14 B/1 A	2539	905	1634	385	184
E 14 B/1 Nom.	2639	905	1734	415	184
E 14 B/2 C	3159	1175	1984	480	260
E 14 B/2 B	3285	1175	2110	700	260
E 14 B/2 A	3455	1175	2280	775	260
E 14 B/2 Nom.	3455	1175	2280	775	260

Max Eff. % =	78,6
Max KW / St.: C - D.240mm =	91,8
Max KW / St.: B - D.250mm =	109,7
Max KW / St. A. - D.259mm =	129,6
Max KW / St. Nom. - D.274mm =	149,6

Q (flow)	25%	50%	75%	100%
NPSH (m)	6	6,4	8,6	16,3

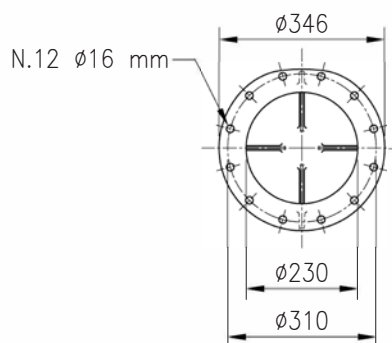
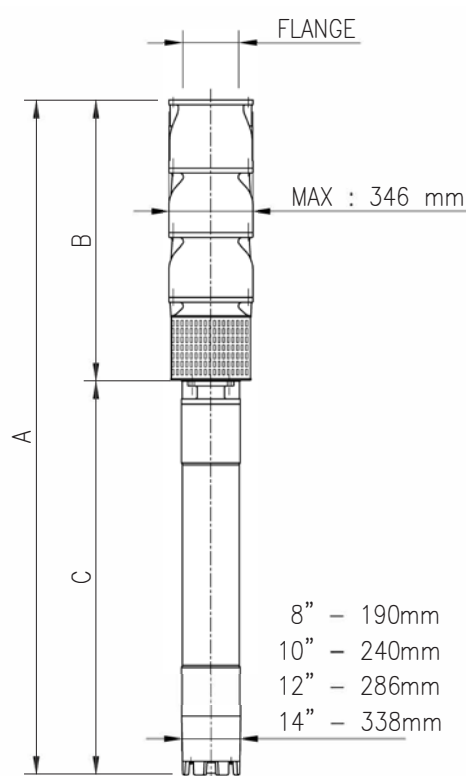

# 14" E14B

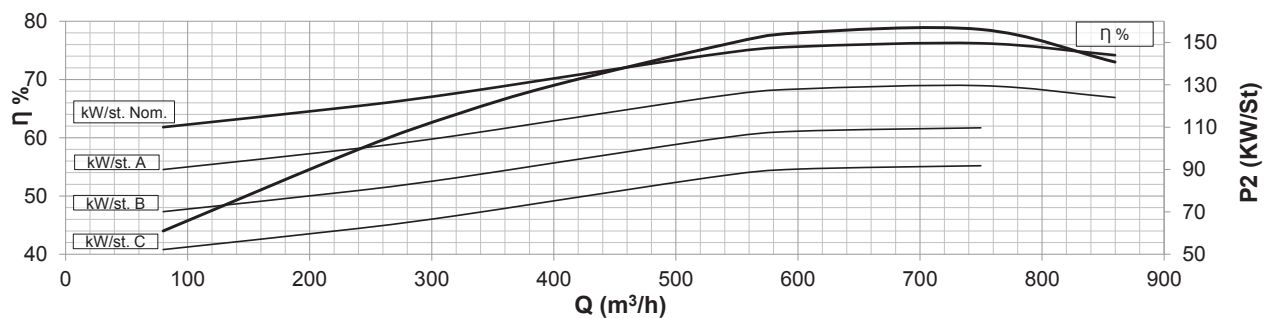
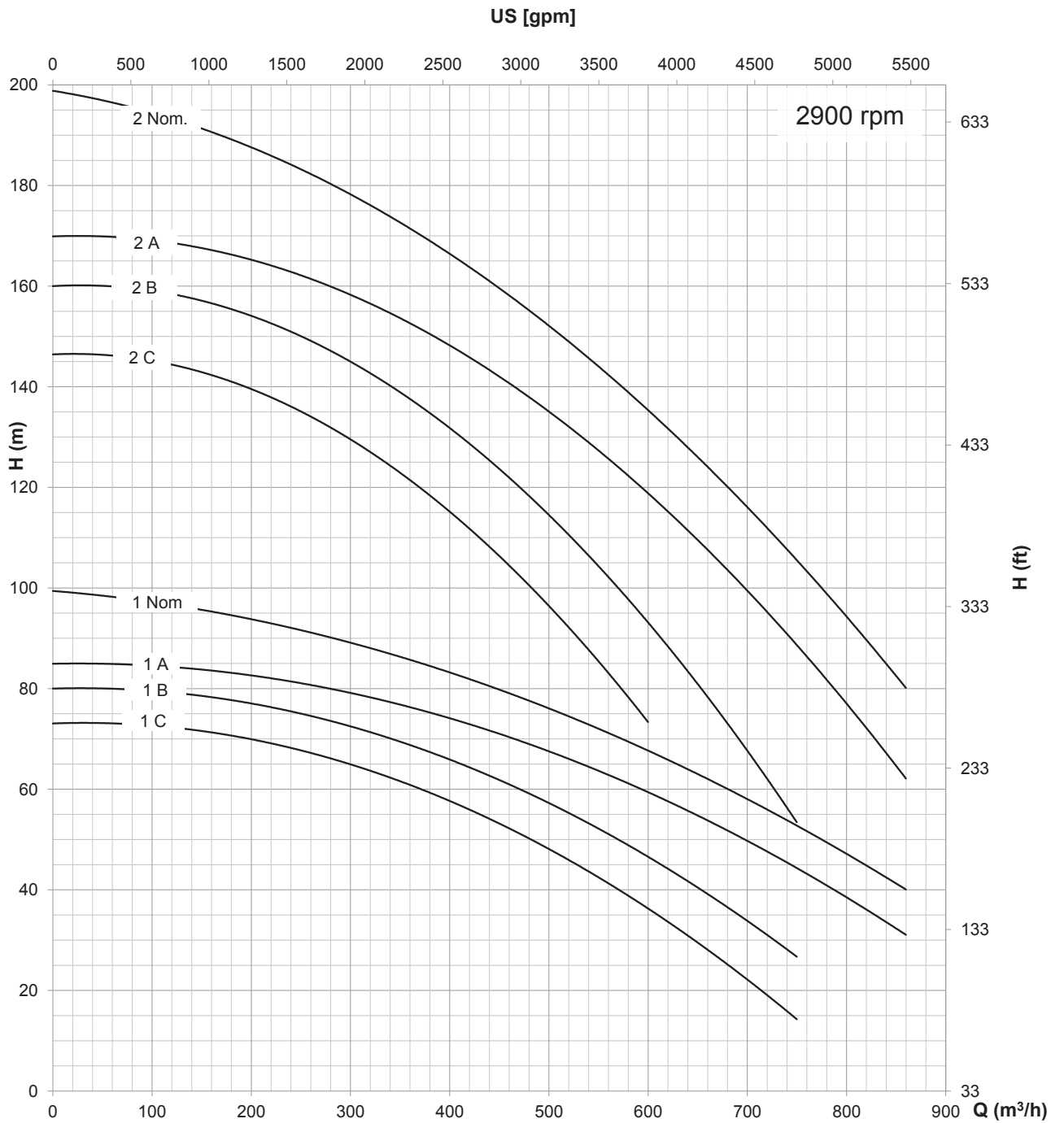

Compatibilità con acqua potabile DM 174 - Drinking water compatibility according DM 174  
 MEI ≥ 0,4 (direttiva EU No. 547/2012 - regulation EU N. 547/2012)  
 Per modelli con meno di 3 stadi ridurre l'eff. % del -5% / Models with less than 3 stages reduce the % eff. of 5%



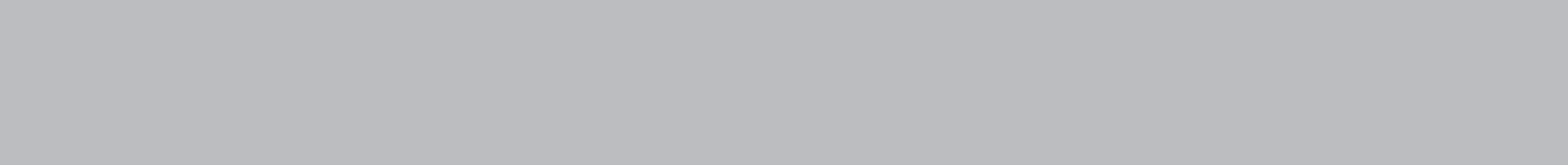

**Disegni esplosi delle pompe  
codici e materiali delle parti di ricambio**

**Pump exploded view  
materials and parts codes of spare parts**

# 6" - 8" LR lines

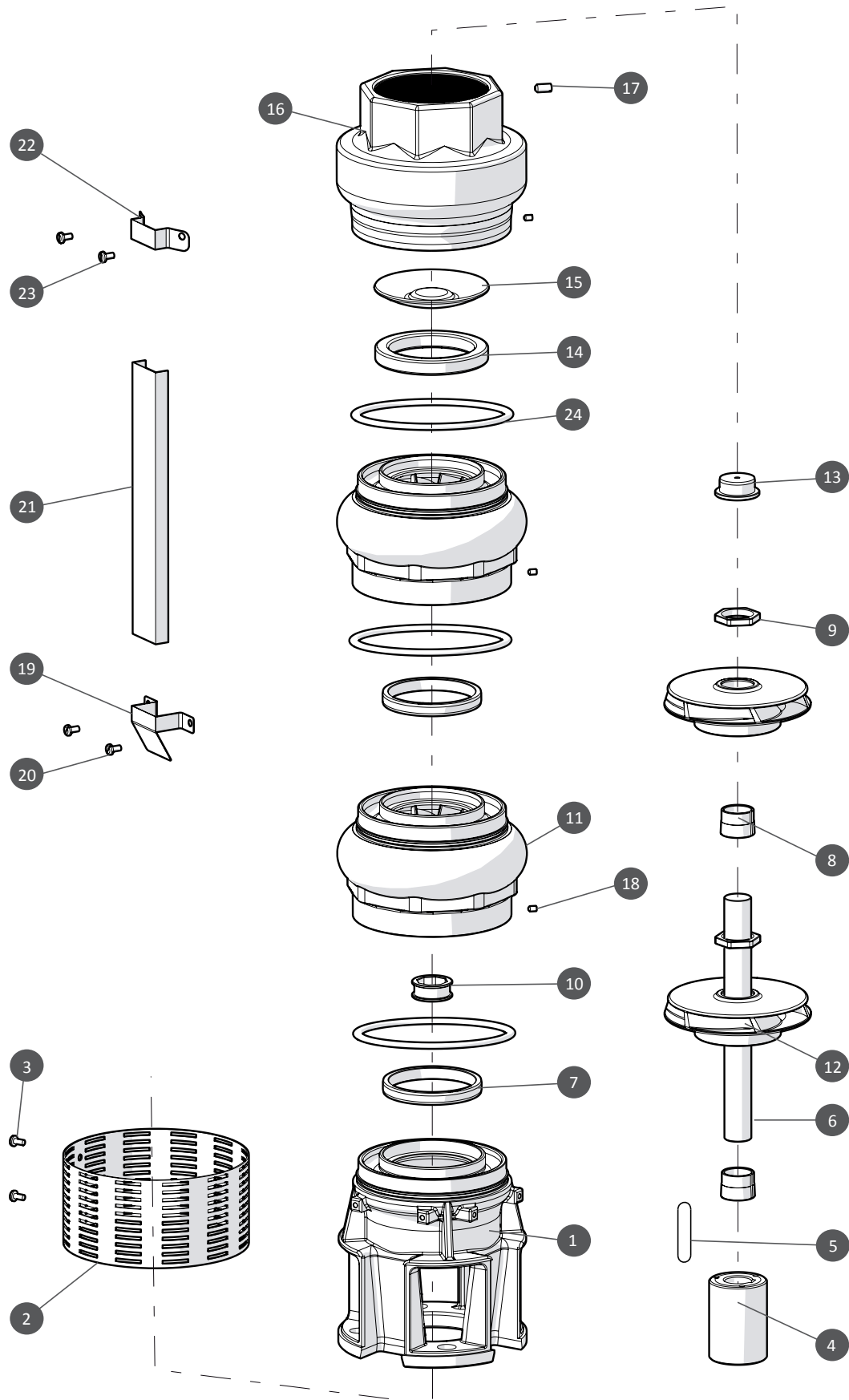



# 6" - 8" LR lines

6LR & 8LR series parts list					
N° Code	DESCRIZIONE Description	LRS Execution	LRX Execution	LRD Execution	(*) Q.tà Q.ty
1	Supporto aspirazione <i>Motor bracket</i>	AISI 304	AISI 316	Duplex	-
2	Filtro aspirazione <i>Suction strainer</i>	AISI 304	AISI 316	Duplex	-
3	Viti M4x8 per filtro <i>M4x8 screws for strainer</i>	AISI 304	AISI 316	Duplex	-
4	Giunto <i>Coupling</i>	AISI 304	AISI 316	Duplex	1
5	Linguetta <i>Key</i>	AISI 304	AISI 316	Duplex	1
6	Albero pompa <i>Pump shaft</i>	AISI 304	AISI 316	Duplex	1
7	Anello usura girante <i>Impeller wear ring</i>	NBR	NBR	NBR	N° di St. N° of St.
8	Anello conico <i>Conic collar</i>	AISI 304	AISI 316	Duplex	N° di St. N° of St.
9	Ghiera <i>Conic collar nut</i>	AISI 304	AISI 316	Duplex	N° di St. N° of St.
10	Bronzina diffusore <i>Diffuser bush bearing</i>	NBR	NBR	NBR	N° di St. N° of St.
11	Diffusore <i>Diffuser</i>	AISI 304	AISI 316	Duplex	-
12	Girante <i>Impeller</i>	AISI 304	AISI 316	Duplex	N° di St. N° of St.
13	Anello controspinta <i>Reverse thrust ring</i>	PTFE+25% CARBONE / Graphite	PTFE+25% CARBONE / Graphite	PTFE+25% CARBONE / Graphite	1
14	Guarnizione valvola di non ritorno <i>NRV gasket</i>	NBR	NBR	NBR	1
15	Disco valvola <i>Valve plate</i>	AISI 304	AISI 316	Duplex	-
16	Corpo di mandata <i>Delivery pump body</i>	AISI 304	AISI 316	Duplex	-
17	Grano bloccaggio tubo di mandata <i>Delivery body locking screw</i>	AISI 304	AISI 316	Duplex	1
18	Grano bloccaggio diffusore <i>Diffuser locking screw</i>	AISI 304	AISI 316	Duplex	N° di St. N° of St.
19	Staffa inferiore copricavo <i>Bottom cable guard clamp</i>	AISI 304	AISI 316	Duplex	-
20	Viti M4x8 per staffa inferiore <i>Bottom cable guard screws M4x8</i>	AISI 304	AISI 316	Duplex	-
21	Copricavo <i>Cable guard</i>	AISI 304	AISI 316	Duplex	-
22	Staffa superiore copricavo <i>Upper cable guard clamp</i>	AISI 304	AISI 316	Duplex	-
23	Viti M4x8 per staffa superiore <i>Upper cable guard screws M4x8</i>	AISI 304	AISI 316	Duplex	-
24	O-Ring <i>O-Ring</i>	NBR	NBR	NBR	N° di St. N° of St.

\* Quantità dei ricambi consigliati / Recommended spare parts quantity

# 6" - 8" - 10" - 12" LM lines

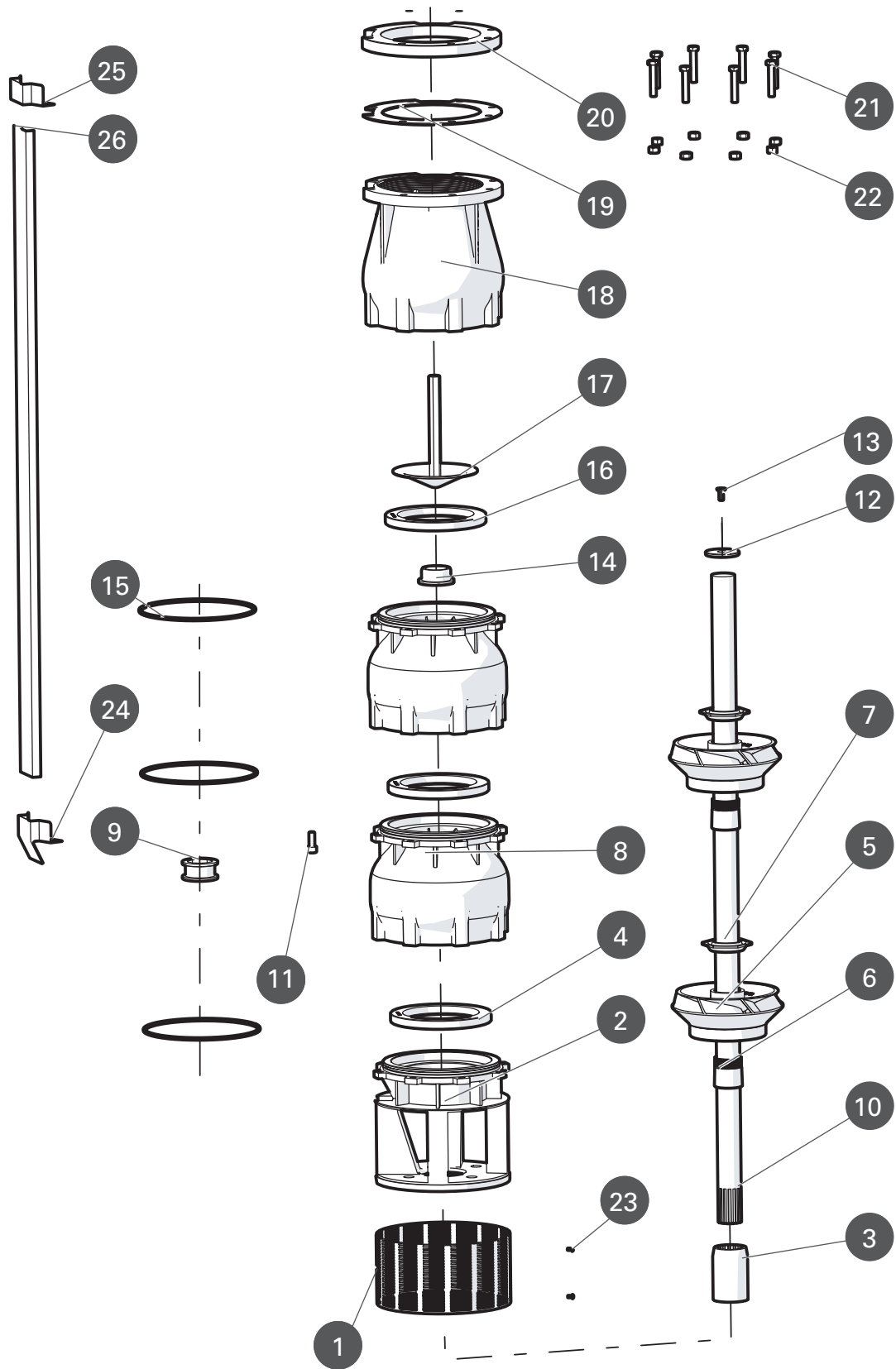

# 6" - 8" - 10" - 12" LM lines

6LM-8LM-10LM-12LM series parts list					
N° Code	DESCRIZIONE Description	LMS Execution	LMX Execution	LMD Execution	(*) Q.tà Q.ty
1	Succheruola <i>Suction strainer</i>	AISI 304	AISI 316	Duplex	-
2	Gabbia di aspirazione <i>Suction cage</i>	AISI 304	AISI 316	Duplex	-
3	Giunto <i>Joint</i>	AISI 304	AISI 316	Duplex	1
4	Anello usura <i>Usury ring</i>	NBR	AISI 316	Duplex	N° di St. N° of St.
5	Girante <i>Impeller</i>	AISI 304	AISI 316	Duplex	-
6	Cono <i>Cone</i>	AISI 304	AISI 316	Duplex	N° di St. N° of St.
7	Ghiera <i>Hexagonal ring</i>	AISI 304	AISI 316	Duplex	N° di St. N° of St.
8	Diffusore <i>Diffuseur</i>	AISI 304	AISI 316	Duplex	-
9	Bronzina <i>Bearing bush</i>	NBR	AISI 316	Duplex	N° di St. N° of St.
10	Albero pompa <i>Pump shaft</i>	AISI 304	AISI 316	Duplex	1
11	N.8 Viti per diffusore <i>N.8 Screw for diffuseur</i>	AISI 304	AISI 316	Duplex	-
12	Disco acciaio <i>Ring</i>	AISI 304	AISI 316	Duplex	1
13	Vite disco acciaio <i>Screw for disk</i>	AISI 304	AISI 316	Duplex	1
14	Controsospensione <i>Counterthrust</i>	PTFE + 25% CARBON	PTFE + 25% CARBON	PTFE + 25% CARBON	1
15	O-Ring <i>O-Ring</i>	NBR	NBR	Duplex	N° di St. N° of St.
16	Guarnizione farfalla <i>Gasket valve</i>	NBR	NBR	Duplex	1
17	Farfalla <i>Cap valve</i>	AISI 304	AISI 316	Duplex	-
18	Corpo valvola <i>Body valve</i>	AISI 304	AISI 316	Duplex	-
19	Guarnizione controflangia <i>Seal counterflange</i>	NBR	NBR	Duplex	1
20	Controflangia <i>Counterflange</i>	AISI 304	AISI 316	Duplex	-
21	N.8 Viti per controflangia <i>N.8 Screw for counterflange</i>	AISI 304	AISI 316	Duplex	-
22	N.8 Dadi per controflangia <i>N.8 Nut for counterflange</i>	AISI 304	AISI 316	Duplex	-
23	N.2 Viti per succheruola <i>N.2 Screw for suction strainer</i>	AISI 304	AISI 316	Duplex	-
24	Staffetta inferiore <i>Lower clamp</i>	AISI 304	AISI 316	Duplex	-
25	Staffetta superiore <i>Upper clamp</i>	AISI 304	AISI 316	Duplex	-
26	Copricavo <i>Cover cable</i>	AISI 304	AISI 316	Duplex	-

\* Quantità dei ricambi consigliati / Recommended spare parts quantity

# 14" E14 lines

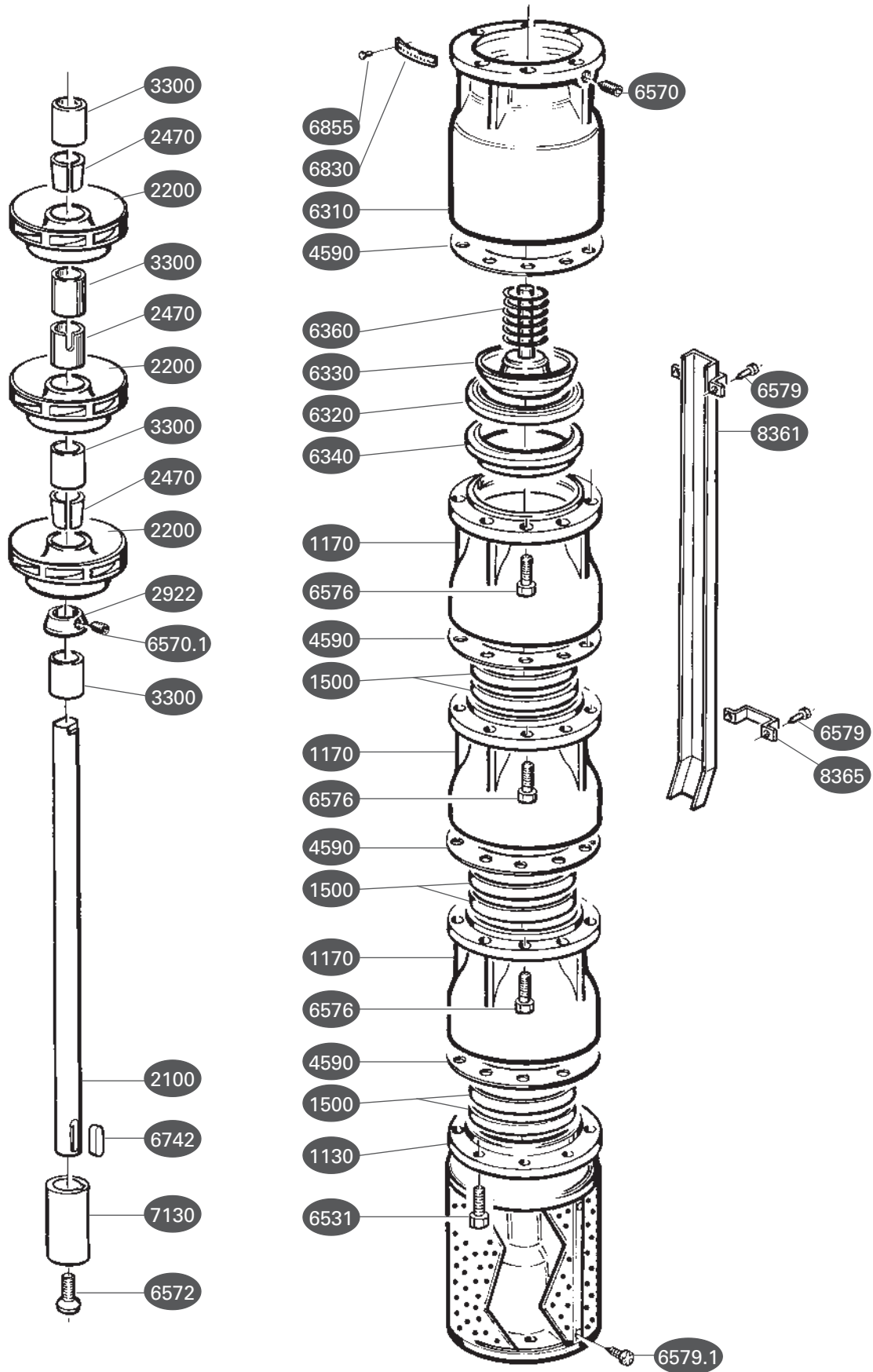

# 14" E14 lines

14" E14 series parts list		
RIF. REF. REF.	DENOMINAZIONE MATERIALE	DENOMINATION MATERIAL
1130	Supporto / Ghisa	Support / Cast iron
1170	Diffusore / Ghisa	Diffuser / Cast iron
1170.1	Ultimo diffusore / Ghisa	Lat diffuser / Cast iron
1500*	Anello usura / Gomma	Wear ring / Rubber
2100	Albero / Acciaio inox	Shaft / Stainless steel
2200*	Girante / Ghisa	Impeller / Cast iron
2470*	Bussola conica / Acciaio	Bushing / Steel
2922*	Parasabbia / Ottone	Sandguard / Brass
3300*	Cuscinetto / Acciaio - gomma	Bearing / Steel - rubber
4590*	Guarnizione / Guarnital	Gland / Guarnital
6310	Corpo valvola / Ghisa	Valve body / Cast Iron
6320	Sede valvola / Ghisa	Valve housing / Rubber
6330	Piattello / Acciaio inox	Washer / Stainless steel
6340	Anello valvola / Ghisa	Housing ring / Cast iron
6360	Molla / Acciaio inox	Spring / Stainless steel
6531	Rete / Acciaio inox	Strainer / Stainless steel
6570	Grano / Acciaio inox	Screw / Stainless steel
6570.1	Grano / Acciaio inox	Screw / Stainless steel
6572	Vite / Acciaio inox	Screw / Stainless steel
6576	Vite / Acciaio inox	Screw / Stainless steel
6579	Vite / Acciaio inox	Screw / Stainless steel
6579.1	Vite / Acciaio inox	Screw / Stainless steel
6742	Linguetta / Acciaio inox	Key / Stainless steel
6830	Targhetta / Acciaio inox	Label / Stainless steel
6855	Rivetto / Acciaio inox	Pin / Stainless steel
7130	Giunto / Acciaio inox	Joint / Stainless steel
8361	Guaina / Acciaio inox	Sheat / Stainless steel
8365	Fascetta copricavo / Acciaio inox	Cable guard Clamp / Stainless steel